

PROPOSED BOUNDARIES
AND FUTURE ANNEXATION AREA OF

CITY OF MODESTO
COMMUNITY FACILITIES DISTRICT NO. 2024-1
(TIVOLI)

COUNTY OF STANISLAUS, STATE OF CALIFORNIA

CITY OF MODESTO CERTIFICATE

1. FILED IN THE OFFICE OF THE CITY CLERK OF THE CITY OF MODESTO,
COUNTY OF STANISLAUS, STATE OF CALIFORNIA THIS _____ DAY
OF _____, 2024

DIANE NAYARES-PEREZ
CITY CLERK, CITY OF MODESTO

2. I HEREBY CERTIFY THAT THE WITHIN MAP SHOWING PROPOSED
BOUNDARIES AND FUTURE ANNEXATION AREA OF COMMUNITY FACILITIES
DISTRICT NO. 2024-1 (TIVOLI) CITY OF MODESTO, COUNTY OF STANISLAUS,
STATE OF CALIFORNIA, WAS APPROVED BY THE CITY COUNCIL OF THE
CITY OF MODESTO, AT A MEETING THEREOF, HELD ON THE
_____ DAY OF _____, 2024, BY ITS RESOLUTION NO.
_____.

DIANE NAYARES-PEREZ
CITY CLERK, CITY OF MODESTO

STANISLAUS COUNTY RECORDER CERTIFICATE

FILED THIS _____ DAY OF _____, 2024, AT THE HOUR OF
_____ O'CLOCK _____ M, IN BOOK _____ OF MAPS OF
ASSESSMENT AND COMMUNITY FACILITIES DISTRICTS AT PAGE _____
IN THE OFFICE OF THE COUNTY RECORDER OF THE COUNTY OF
STANISLAUS, STATE OF CALIFORNIA.

DONNA LINDER
CLERK RECORDER
COUNTY OF STANISLAUS,
STATE OF CALIFORNIA

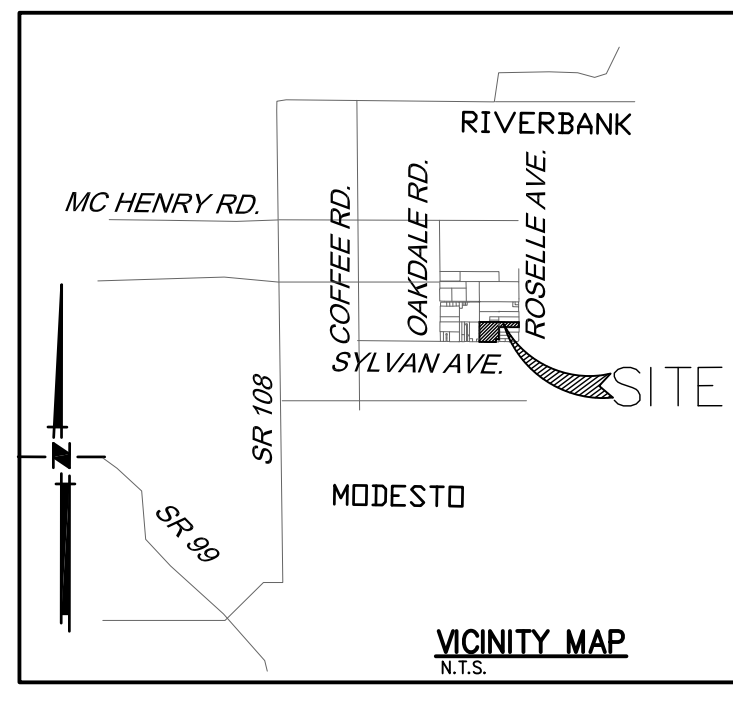

ASSESSORS PARCELS
WITHIN CFD 2024-1

MAP INDEX NUMBER	ASSESSORS PCL. NUMBER
2	083-004-059-000
3	083-004-060-000
4	083-004-068-000

ASSESSORS PARCELS
WITHIN FUTURE
ANNEXATION AREA

MAP INDEX NUMBER	ASSESSORS PCL. NUMBER
1	083-003-017-000
5	083-004-076-000
6	083-004-083-000
7	083-004-088-000
8	083-003-003-000
9	083-003-014-000
10	083-003-015-000
11	083-003-016-000
12	083-004-008-000
13	083-004-013-000
14	083-004-023-000
15	083-004-043-000
16	083-004-044-000
17	083-004-047-000
18	083-004-048-000
19	083-004-050-000
20	083-004-057-000
21	083-004-058-000
22	083-004-063-000
23	083-004-064-000
24	083-004-070-000
25	083-004-071-000
26	083-004-072-000
27	083-004-073-000
28	083-004-078-000
29	083-004-079-000
30	083-004-085-000
31	083-004-086-000
32	083-004-087-000
33	083-005-016-000



NOTES:

1. REFERENCE IS HEREBY MADE TO THE MAPS AND DEEDS OF RECORD IN THE OFFICE OF THE ASSESSOR OF THE COUNTY OF STANISLAUS FOR THE DETAILED DESCRIPTION OF THE LINES AND DIMENSIONS OF ANY PARCELS SHOWN HEREON.

LEGEND

- ASSESSOR'S PARCEL LOT LINE
- COMMUNITY FACILITIES DISTRICT NO. 2024-1 AND IMPROVEMENT AREA NO.1
- ▨ FUTURE ANNEXATION AREA
- ⑩ MAP INDEX NUMBER

GRAPHIC SCALE

