



MODESTO

CALIFORNIA

City of Modesto
LANDSCAPE MAINTENANCE ASSESSMENT DISTRICT No. 1
◆ DRY CREEK MEADOWS SUBDIVISIONS Nos. 1 through 6 ◆
*A Landscape Maintenance Assessment District pursuant to
the Landscape and Lighting Act of 1972*

ENGINEER'S ANNUAL REPORT

FISCAL YEAR
JULY 1, 2022 - JUNE 30, 2023



Prepared By:

Jessica Hill
Community Development Manager

Certified By:

Nathan Bray, **P.E.**
Interim City Engineer

Accepted By Motion:

Modesto City Council

TABLE OF CONTENTS

<u>SECTION</u>	<u>TITLE</u>
I.	History
II.	Annual Assessment Review & Summary
III.	Financials – Annual Assessment Revenue & Expense Projections
IV.	Maintenance & Plan Specifications
V.	Annual Assessment District Diagram
VI.	Annual Assessments List by Parcel & Property Owner

SECTION I HISTORY

On December 12, 1988, Landscape Maintenance Assessment District No. 1 (“LMAD No. 1”) was formed in accordance with the Landscape and Lighting Act of 1972 (California Streets and Highway Code §22500 through §22679) (“the Act”), to administer the maintenance of landscaping in the public right-of-way within the street medians and adjacent to the access control walls in Dry Creek Meadows Subdivisions Nos. 1-6. All costs for the LMAD No. 1 are funded by the annual assessments levied on each property within the district. The Act requires several courses of action on the part of City staff and City Council prior to August 10th of each year.

The Act initially requires the City Council to order, prepare, and file an Engineer’s Annual Report for the City Council. This report is prepared for the purpose of detailing the plans and specifications for the maintenance of work, the estimated costs for landscape maintenance performed by City contractors, utility service charges, City street tree pruning costs, City staff time to administer the maintenance contract, and additional work to be performed by the City Contractor at the request of the City.

LMAD No. 1 is located east of North McClure Road and southwest of MID Lateral #2 and Claus Road. It is comprised of 749 single-family residential lots and three (3) public agency owned parcels. An annual assessment of \$26 per single-family residential parcel has remained the same since 1996. The total assessment to be levied for LMAD No. 1 for Fiscal Year 2022-2023 is \$19,474.

Upon the City Council’s approval of the Engineer’s Annual Report, the City Council adopts a resolution declaring its intent to levy and collect assessments within LMAD No. 1 for the following fiscal year and schedules a public hearing. This public hearing and proposed resolution levying the proposed assessments is in accordance with the annual assessment procedures.

Finally, in compliance with the Act, the City Council conducts the public hearing and adopts certain resolutions in accordance with the California Streets and Highways Code §22625 through §22641. The City Clerk is required to give the Modesto Bee notice of the public hearing no less than ten (10) days prior to the scheduled hearing date. All interested persons are afforded the opportunity to be heard during the public hearing. Should there be any protests, whether written or oral, the City Council may choose to continue the hearing to a later date and/or may change any part of the Engineer’s Annual Report to address the concerns of the property owner(s). The adopted resolution is then forwarded to the Auditor-Controller of the County of Stanislaus for placement of such charges on the upcoming year’s County Tax Roll.

SECTION II ANNUAL ASSESSMENT REVIEW AND SUMMARY

A. PARCEL REVIEW

1. Single Family Residential Parcels:
There are 749 single-family residential parcels located within LMAD No. 1.
2. Multi-Family Residential Parcels:
There are no multi-family residential parcels located within LMAD No. 1.
3. Commercial/Industrial Parcels:
There are no commercial or industrial parcels located within LMAD No. 1.
4. Public Agency Parcels:
There are two (2) parcels owned by the City of Modesto (Creekwood Park and the Pedestrian Overcrossing at Claus Road) and one (1) parcel owned by the Empire School District (Bernard Hughes School). According to §22663 of the California Streets and Highways Code, public property owned by any public agency and in use in the performance of a public function shall not be subject to assessment.

B. 2022-2023 ANNUAL ASSESSMENTS

All single-family residential parcels are levied at a flat rate of \$26.00 per parcel. Each parcel receives equal benefits from the District. The Stanislaus County Auditor-Controller's Office, Property Taxes and Assessments Division, collects a \$0.20 fee per assessment and per parcel. This fee is built into the annual assessment being levied for LMAD No. 1. The annual assessments levied are calculated by multiplying the total number of parcels by the flat rate.

\$	26.00	Annual assessment per parcel
x	749	Single-family residential parcels
\$	19,474.00	Total annual assessment

C. COMPARISON TO PREVIOUS FISCAL YEAR

The proposed Fiscal Year 2022-2023 annual assessment is the same as the annual assessment for Fiscal Year 2021-2022 of \$26.00 per single-family residential parcel.

SECTION III FINANCIALS – ANNUAL ASSESSMENT REVENUE & EXPENSE PROJECTIONS

LMAD No. 1 Fund 6480		Estimated FY 2021-22 ¹	Proposed FY 2022-23 ²
Beginning Fund Balance		\$ 7,070	\$ 8,410
Revenue (Cost Center 80010)			
Special Assessments		\$ 11,083 ³	\$ 19,324 ⁴
Interest		\$ 8	
<i>Estimated - Special Assessments</i>		\$ 8,391 ⁵	
Total Revenue		\$ 19,482	\$ 19,324
Expenses (Cost Center 80010)	Account		
<i>Operating Budget</i>			
Postage Expenses	52025	\$ -	\$ -
Water Utility Expenses	53043	\$ (3,225)	\$ (4,500)
Repair and Maintenance Services - Landscape	53165	\$ (4,860)	\$ (8,687)
Professional Services	53300	\$ -	\$ (1,000)
Legal Services	53450	\$ -	\$ (500)
Services City Forces - Interfund	54500	\$ (1,368)	\$ (3,790)
<i>Estimated - Water Utility Expenses</i>	53043	\$ (1,275)	
<i>Estimated - Repair and Maintenance Services</i>	53165	\$ (5,730)	
<i>Estimated - Professional Services</i>	53300	\$ (1,000)	
<i>Estimated - Legal Services</i>	53450		
<i>Estimated - Services City Forces</i>	54500	\$ (684)	
Total Expenses		\$ (18,142)	\$ (18,477)
Ending Fund Balance		\$ 8,410	\$ 9,257
¹ The final amount shows what has been expended as of 02.28.22 in FY22. There will be more expenses through the end of the fiscal year (June); these are shown as Estimated.			
² The estimated expenditures for FY 2022-23 are based on the revenue that is currently able to be generated within LMAD No. 1.			
³ Actual revenue received for FY 2021-22 tax levy.			
⁴ Proposed revenue			
⁵ Estimated revenues for second installment of FY 2021-22 tax levy.			

SECTION IV MAINTENANCE & PLAN SPECIFICATIONS

Plans and specifications are available for review in the Public Works Department, located at 512 Jefferson Street, Modesto, CA. For more information, contact Kelly Gallagher, Parks Operations Manager at (209) 342-2270.

SECTION V ANNUAL ASSESSMENT DISTRICT DIAGRAM

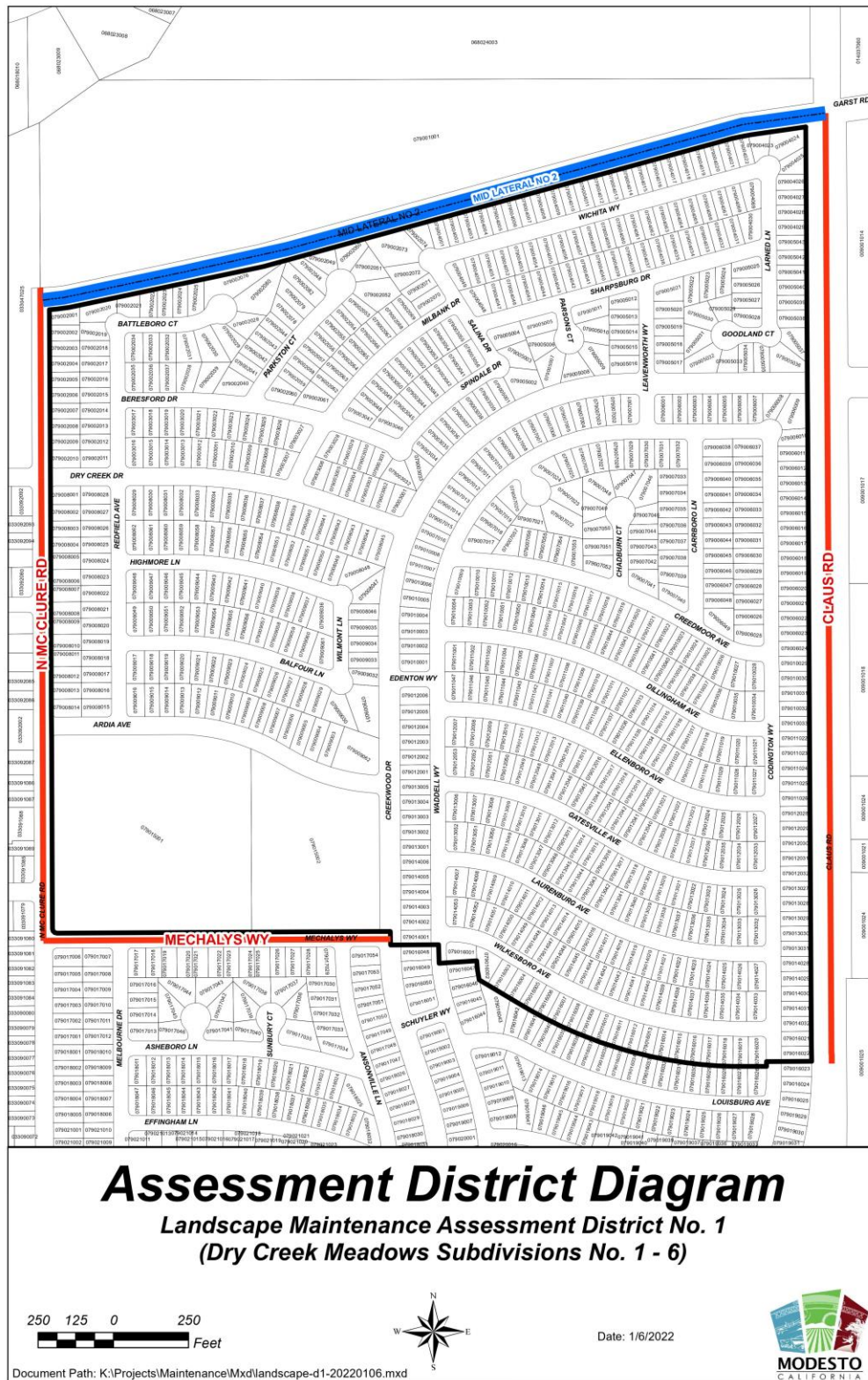

SECTION VI ANNUAL ASSESSMENT LIST BY PARCEL & OWNER

Fee Parcel	Owner	Address	City State Zip	2022-23 Ast.
079-002-001-000	MERCADO LISA M & RODOLFO	736 N MC CLURE RD	Modesto CA 95357	\$26.00
079-002-002-000	SOUMPHONPHAKDY YOUTHANA	732 N MC CLURE RD	Modesto CA 95357	\$26.00
079-002-003-000	SORDO BRYON S ET AL	728 N MC CLURE RD	Modesto CA 95357	\$26.00
079-002-004-000	PRASAD AJAY B & CHANDRA SAILESHNI D	724 N MC CLURE RD	Modesto CA 95357	\$26.00
079-002-005-000	LOPEZ JOSE M	720 N MC CLURE RD	Modesto CA 95354	\$26.00
079-002-006-000	YATES MICHAEL V & YATES CHRISTINE M	716 N MC CLURE RD	Modesto CA 95357	\$26.00
079-002-007-000	ALBANO FLORANTE J & ALBANO JUANITA T	712 N MC CLURE RD	Modesto CA 95354	\$26.00
079-002-008-000	GARCIA JOSE DE JESUS	708 N MC CLURE RD	Modesto CA 95354	\$26.00
079-002-009-000	ESPINOZA GABRIEL	704 N MC CLURE RD	Modesto CA 95357	\$26.00
079-002-010-000	LEON MARTHA	700 N MC CLURE RD	Modesto CA 95357	\$26.00
079-002-011-000	SAMRA AMARJIT S TR	701 REDFIELD AVE	Modesto CA 95357	\$26.00
079-002-012-000	BARRIENTOS DAVID & BARRIENTOS MARIA E	705 REDFIELD AVE	Modesto CA 95357	\$26.00
079-002-013-000	YOUNGMAN AARON B & LAUREN E	709 REDFIELD AVE	Modesto CA 95357	\$26.00
079-002-014-000	BATTAGLIA COREY J	713 REDFIELD AVE	Modesto CA 95357	\$26.00
079-002-015-000	BADAL EDWARD E & BADAL JANET E	717 REDFIELD AVE	Modesto CA 95357	\$26.00
079-002-016-000	NGUYEN THANG & DANG LIEN	721 REDFIELD AVE	Modesto CA 95357	\$26.00
079-002-017-000	SMITH ROBIN K & SMITH SUSAN R	725 REDFIELD AVE	Modesto CA 95357	\$26.00
079-002-018-000	WRIGHT JASON ET AL	729 REDFIELD AVE	Modesto CA 95357	\$26.00
079-002-019-000	VAZQUEZ MIRIAM S	733 REDFIELD AVE	Modesto CA 95357	\$26.00
079-002-020-000	CASEY MARY JOHN	737 REDFIELD AVE	Modesto CA 95357	\$26.00
079-002-021-000	PANYANOUVONG ROCKY P ET AL	3513 BATTLEBORO CT	Modesto CA 95357	\$26.00
079-002-022-000	JOHNSON VERDELL TR	3517 BATTLEBORO CT	Modesto CA 95357	\$26.00
079-002-023-000	VILLEGAS JOSEPH J	3521 BATTLEBORO CT	Modesto CA 95357	\$26.00
079-002-024-000	PLUNK NATALIE & ROBERT	3525 BATTLEBORO CT	Modesto CA 95357	\$26.00
079-002-025-000	HASKEL ALAN	3529 BATTLEBORO CT	Modesto CA 95357	\$26.00
079-002-028-000	ALVAREZ VICTOR R & CRISTINA TRS	3536 BATTLEBORO CT	Modesto CA 95357	\$26.00
079-002-029-000	HASKEL ROBERT	3532 BATTLEBORO CT	Modesto CA 95357	\$26.00
079-002-030-000	EMERY EVERETTE & SHONDA TRS	3528 BATTLEBORO CT	Modesto CA 95357	\$26.00
079-002-031-000	VILLALPANDO HERIBERTO & ROSA	3524 BATTLEBORO CT	Modesto CA 95357	\$26.00
079-002-032-000	NGUYEN HUY ET AL	3520 BATTLEBORO CT	Modesto CA 95357	\$26.00
079-002-033-000	PRASHAD RAJENDRA & SONI L	3516 BATTLEBORO CT	Modesto CA 95357	\$26.00
079-002-034-000	VO SANG	3512 BATTLEBORO CT	Modesto CA 95357	\$26.00
079-002-035-000	ALCAZAR ELISA C ET AL	3513 BERESFORD DR	Modesto CA 95357	\$26.00
079-002-036-000	CARREON JOSE & CECILIA	3517 BERESFORD DR	Modesto CA 95357	\$26.00
079-002-037-000	GOMEZ PATRICIA	3521 BERESFORD DR	Modesto CA 95357	\$26.00
079-002-038-000	COENEN KELVIN L & COENEN CHRISTINA P	3525 BERESFORD DR	Modesto CA 95357	\$26.00
079-002-039-000	BECERRA JUAN CARLOS RIVERA	3529 BERESFORD DR	Modesto CA 95357	\$26.00
079-002-040-000	CARSON SAMMY D & CARSON BRENDA S	713 PARKSTON CT	Modesto CA 95357	\$26.00
079-002-041-000	ALLEN FLETCHER	717 PARKSTON CT	Modesto CA 95357	\$26.00
079-002-042-000	SOTO HECTOR M & PENNA MARIA C	721 PARKSTON CT	Modesto CA 95357	\$26.00
079-002-043-000	SAMRA AMARJIT	725 PARKSTON CT	Modesto CA 95357	\$26.00
079-002-044-000	WRIGHT JASON ODELL SR & SARA	729 PARKSTON CT	Modesto CA 95357	\$26.00
079-002-048-000	SINGH JOTIKA ET AL	745 PARKSTON CT	Modesto CA 95357	\$26.00
079-002-049-000	TOWNSELL DARNELL JR ET AL	749 PARKSTON CT	Modesto CA 95357	\$26.00
079-002-050-000	ALTON KARIM YOKHANA TR	753 PARKSTON CT	Modesto CA 95357	\$26.00
079-002-051-000	TORRES JUAN LUIS	752 PARKSTON CT	Modesto CA 95357	\$26.00
079-002-052-000	CASTILLO RANDY	748 PARKSTON CT	Modesto CA 95357	\$26.00
079-002-053-000	LANZA PHILIP R	744 PARKSTON CT	Modesto CA 95357	\$26.00
079-002-054-000	FABER BRUCE ET AL	740 PARKSTON CT	Modesto CA 95357	\$26.00
079-002-055-000	PEREZ ISIDRO C	736 PARKSTON CT	Modesto CA 95357	\$26.00
079-002-056-000	GANJA SAM	732 PARKSTON CT	Modesto CA 95357	\$26.00
079-002-057-000	GUEVARA NICOLAS A & MARIA C	728 PARKSTON CT	Modesto CA 95357	\$26.00
079-002-058-000	COLLS LUIS R TR	724 PARKSTON CT	Modesto CA 95357	\$26.00

Fee Parcel	Owner	Address	City State Zip	2022-23 Ast.
079-002-059-000	MUSIC DAVID T & PATRICIA A	720 PARKSTON CT	Modesto CA 95357	\$26.00
079-002-060-000	CLARKE THOMAS D II & BRENDA L	716 PARKSTON CT	Modesto CA 95355	\$26.00
079-002-061-000	CASTIGLIONE JOSEPH B & BECKY M	713 MILBANK DR	Modesto CA 95357	\$26.00
079-002-062-000	LUBINSKY EDWARD & LUBINSKY CAROL E	717 MILBANK DR	Modesto CA 95354	\$26.00
079-002-063-000	CASTILLO HECTOR	721 MILBANK DR	Modesto CA 95357	\$26.00
079-002-064-000	PRASAD RAMA ET AL TRS	725 MILBANK DR	Modesto CA 95357	\$26.00
079-002-065-000	WINGO NAIDA J ET AL	729 MILBANK DR	Modesto CA 95357	\$26.00
079-002-066-000	SMITH MARQUE R	733 MILBANK DR	Modesto CA 95357	\$26.00
079-002-067-000	VILLANUEVA DAVID M & VILLANUEVA DIANE M	737 MILBANK DR	Modesto CA 95357	\$26.00
079-002-068-000	PETERSON JEAN	741 MILBANK DR	Modesto CA 95357	\$26.00
079-002-069-000	MORSE GERALD WAYNE & CONSUELO	745 MILBANK DR	Modesto CA 95357	\$26.00
079-002-070-000	RAMIREZ-RIVERA JULIO C & CRUZ-FUENTES ALMA NIDIA	817 SALINA DR	Modesto CA 95357	\$26.00
079-002-071-000	CONTRERAS JESUS E RAMOS & RAMOS ANGELICA CARRASC	821 SALINA DR	Modesto CA 95357	\$26.00
079-002-072-000	SALAZAR JENNIFER	825 SALINA DR	Modesto CA 95357	\$26.00
079-002-073-000	MANANQUIL DEXTER & PRAK DEBBIE	3701 WICHITA WAY	Modesto CA 95357	\$26.00
079-002-074-000	ROMAN TED ET AL	3705 WICHITA WAY	Modesto CA 95357	\$26.00
079-002-076-000	BATES HAROLD & JANICE	3533 BATTLEBORO CT	Modesto CA 95357	\$26.00
079-002-078-000	SINGH MOHINDER	733 PARKSTON CT	Modesto CA 95357	\$26.00
079-002-079-000	SINGH DALVIR	737 PARKSTON CT	Modesto CA 95357	\$26.00
079-002-080-000	HASKEL ROBERT P	3537 BATTLEBORO CT	Modesto CA 95357	\$26.00
079-002-082-000	SIMAS LUIS & DAISY	741 PARKSTON CT	Modesto CA 95357	\$26.00
079-003-001-000	MAHARAJ SANJAI S & MAHARAJ ARUNA D	3641 DRY CREEK DR	Modesto CA 95357	\$26.00
079-003-002-000	HUFFMAN JOSEPH R II & MARLENE J	3637 DRY CREEK DR	Modesto CA 95357	\$26.00
079-003-003-000	BROWN CHRISTOPHER C & KAREN R	3633 DRY CREEK DR	Modesto CA 95357	\$26.00
079-003-004-000	CALVO SERGIO & SILVIA	3629 DRY CREEK DR	Modesto CA 95357	\$26.00
079-003-005-000	TORRES MOSES & ESTRADA NANCY	3625 DRY CREEK DR	Modesto CA 95357	\$26.00
079-003-006-000	MAGCALAS JOEL & VIRGINIA	3621 DRY CREEK DR	Modesto CA 95357	\$26.00
079-003-007-000	CORDOVA ISIDRO C & CORDOVA MARTHA B	3613 DRY CREEK DR	Modesto CA 95357	\$26.00
079-003-008-000	CHUANGS INVESTMENT INC	3609 DRY CREEK DR	Modesto CA 95357	\$26.00
079-003-009-000	PRASAD SUJENDRA & DEVI SANGITA	3605 DRY CREEK DR	Modesto CA 95357	\$26.00
079-003-010-000	GIL MARTIN & GIL DEBORAH L	3601 DRY CREEK DR	Modesto CA 95357	\$26.00
079-003-011-000	DOUGLAS GREG & DOUGLAS TERI	3537 DRY CREEK DR	Modesto CA 95357	\$26.00
079-003-012-000	HERNANDEZ FERNANDO PARDO & HERNANDEZ GLORIA C	3533 DRY CREEK DR	Modesto CA 95357	\$26.00
079-003-013-000	CHERRY RANDY L & ROSALBA	3529 DRY CREEK DR	Modesto CA 95357	\$26.00
079-003-014-000	REYES FERNANDO ET AL	3525 DRY CREEK DR	Modesto CA 95357	\$26.00
079-003-015-000	CHUON LEE ET AL	3521 DRY CREEK DR	Modesto CA 95357	\$26.00
079-003-016-000	DIXON THOMAS L TR	3517 DRY CREEK DR	Modesto CA 95357	\$26.00
079-003-017-000	WISNER JAMES E & ELINA S	3512 BERESFORD DR	Modesto CA 95354	\$26.00
079-003-018-000	ESTRADA ADRIANA G	3516 BERESFORD DR	Modesto CA 95357	\$26.00
079-003-019-000	DELANEY KIMBERLY R	3520 BERESFORD DR	Modesto CA 95357	\$26.00
079-003-020-000	LOVE BOBBY	3524 BERESFORD DR	Modesto CA 95357	\$26.00
079-003-021-000	DHALIWAL JOGINDER SINGH & KULWANT KAUR	3528 BERESFORD DR	Modesto CA 95357	\$26.00
079-003-022-000	LUTTRELL ERIC ET AL	3532 BERESFORD DR	Modesto CA 95357	\$26.00
079-003-023-000	MENDOZA ADRIAN & ROSA	3536 BERESFORD DR	Modesto CA 95357	\$26.00
079-003-024-000	GARCIA JOSE VASQUEZ & MOSQUEDA LAURA CALDERON	3540 BERESFORD DR	Modesto CA 95357	\$26.00
079-003-025-000	FISCHER WILLIAM & FISCHER CAROL	3600 BERESFORD DR	Modesto CA 95357	\$26.00
079-003-026-000	ARELLANO ERIK ALBERTO	3604 BERESFORD DR	Modesto CA 95357	\$26.00
079-003-027-000	PRAKASH OM & SUSHIL	3608 BERESFORD DR	Modesto CA 95357	\$26.00
079-003-028-000	REYES ERLINDA M TR	3616 BERESFORD DR	Modesto CA 95357	\$26.00
079-003-029-000	CHUNG WILLIAM & YEH GEORGINA PIK-CHING TRS	3620 BERESFORD DR	Modesto CA 95357	\$26.00
079-003-030-000	BURKE GARY F II & JEAN-BURKE BECKY TRS	3624 BERESFORD DR	Modesto CA 95357	\$26.00
079-003-031-000	MUNOZ ALFREDO F & CEYLON A	3628 BERESFORD DR	Modesto CA 95357	\$26.00
079-003-032-000	SAENGPACHANH PHONESY ET AL	3632 BERESFORD DR	Modesto CA 95357	\$26.00
079-003-033-000	ROTH WILLIAM C & ROTH DOLORES	704 SPINDALE DR	Modesto CA 95350	\$26.00
079-003-034-000	SOLIS MARIA	708 SPINDALE DR	Modesto CA 95357	\$26.00

Fee Parcel	Owner	Address	City State Zip	2022-23 Ast.
079-003-035-000	LANGI SOANE	712 SPINDALE DR	Modesto CA 95357	\$26.00
079-003-036-000	SHARMA RUDRA DUTT & RESHMIKA	716 SPINDALE DR	Modesto CA 95357	\$26.00
079-003-037-000	DEL REAL INDELACIO & DEL REAL ELENA	720 SPINDALE DR	Modesto CA 95357	\$26.00
079-003-038-000	MORALES DIANA R	724 SPINDALE DR	Modesto CA 95357	\$26.00
079-003-039-000	MONTELONGO SANDRO	728 SPINDALE DR	Modesto CA 95357	\$26.00
079-003-041-000	GONZALES JUAN G JR & GLORIA M	729 SPINDALE DR	Modesto CA 95357	\$26.00
079-003-042-000	DORRETT NEWTON & LYNELL D	725 SPINDALE DR	Modesto CA 95357	\$26.00
079-003-043-000	SAMMULI ROBERT A & JAMIE L	721 SPINDALE DR	Modesto CA 95357	\$26.00
079-003-044-000	GARCIA ERIKA YAZMIN	717 SPINDALE DR	Modesto CA 95357	\$26.00
079-003-045-000	REYES ROGELIO GONZALEZ	713 SPINDALE DR	Modesto CA 95357	\$26.00
079-003-046-000	BOWMAN ANDREW	709 SPINDALE DR	Modesto CA 95357	\$26.00
079-003-047-000	SINGH RAWNIK & LAL RANJITA	3617 BERESFORD DR	Modesto CA 95357	\$26.00
079-003-048-000	COULIBALY LLC	720 MILBANK DR	Modesto CA 95357	\$26.00
079-003-049-000	MOODY DIANE K	724 MILBANK DR	Modesto CA 95357	\$26.00
079-003-050-000	SWITZER LYNDELL TR	728 MILBANK DR	Modesto CA 95357	\$26.00
079-003-051-000	KILGORE LINDA L	732 MILBANK DR	Modesto CA 95357	\$26.00
079-003-052-000	MAXWELL VIRGINIA E	736 MILBANK DR	Modesto CA 95357	\$26.00
079-003-053-000	JUDD JIMMIE RANDALL ET AL	740 MILBANK DR	Modesto CA 95357	\$26.00
079-003-054-000	SPIEKER JANE R & DAVID M	744 MILBANK DR	Modesto CA 95357	\$26.00
079-003-055-000	ALVEAR FELICITAS	748 MILBANK DR	Modesto CA 95357	\$26.00
079-003-056-000	PAHL KAREN M ET AL	733 SPINDALE DR	Modesto CA 95357	\$26.00
079-004-001-000	ESPARZA WILLIAM & ELSA	3709 WICHITA WAY	Modesto CA 95357	\$26.00
079-004-002-000	CASSIDY ALAN K & CASSIDY SUSAN H	3713 WICHITA WAY	Modesto CA 95357	\$26.00
079-004-003-000	HAWIL ALFRED	3717 WICHITA WAY	Modesto CA 95357	\$26.00
079-004-004-000	PALMERIN ARTURO & PATRICIA	3721 WICHITA WAY	Modesto CA 95357	\$26.00
079-004-005-000	PAPPAS MICHAEL & NANCY CARDENAS	3725 WICHITA WAY	Modesto CA 95357	\$26.00
079-004-006-000	MANLULU NOEL M & MANLULU MARIVIC F	3729 WICHITA WAY	Modesto CA 95357	\$26.00
079-004-007-000	TOWNE JAMES E & TOWNE AMANDA J	3733 WICHITA WAY	Modesto CA 95357	\$26.00
079-004-008-000	VALDES RENE D ET AL	3801 WICHITA WAY	Modesto CA 95357	\$26.00
079-004-009-000	DE ALBA RIGOBERTO SR & SANDRA L TRS	3805 WICHITA WAY	Modesto CA 95357	\$26.00
079-004-010-000	DE ALBA RIGOBERTO SR & SANDRA L TRS	3809 WICHITA WAY	Modesto CA 95357	\$26.00
079-004-011-000	WATTLE DANNY & CAROLANNE	3813 WICHITA WAY	Modesto CA 95357	\$26.00
079-004-012-000	HECKLER LAWRENCE S TR	3817 WICHITA WAY	Modesto CA 95357	\$26.00
079-004-013-000	ROMERO EDUARDO ANTONIO ELIAS	3821 WICHITA WAY	Modesto CA 95357	\$26.00
079-004-014-000	CURTRIGHT BARBARA TR	3825 WICHITA WAY	Modesto CA 95357	\$26.00
079-004-015-000	HAWIL MARCUS	3829 WICHITA WAY	Modesto CA 95354	\$26.00
079-004-016-000	GETREU DANIEL L & GETREU PATRICIA E	3901 WICHITA WAY	Modesto CA 95354	\$26.00
079-004-017-000	FUENTES MANUEL	3905 WICHITA WAY	Modesto CA 95357	\$26.00
079-004-018-000	GONZALEZ CARRAZCO LUIS A & BUENDIA ANA L	3909 WICHITA WAY	Modesto CA 95357	\$26.00
079-004-019-000	ALBERG DAVID A & PAMELA M TRS	3913 WICHITA WAY	Modesto CA 95354	\$26.00
079-004-020-000	BOWMAN TERRI	3917 WICHITA WAY	Modesto CA 95357	\$26.00
079-004-021-000	COX JULIE A	3921 WICHITA WAY	Modesto CA 95355	\$26.00
079-004-022-000	TEJEDA SERGIO L & VALDEZ JUANA ROCIO QUINTANILLA	3925 WICHITA WAY	Modesto CA 95357	\$26.00
079-004-023-000	MEZA HECTOR MEDINA	3929 WICHITA WAY	Modesto CA 95357	\$26.00
079-004-024-000	MARTINEZ ARTHUR J & ELISA R	3933 WICHITA WAY	Modesto CA 95357	\$26.00
079-004-025-000	GARDNER GEORGE & GARDNER DAWN	844 LARNED LN	Modesto CA 95357	\$26.00
079-004-026-000	SAMUEL BENJAMIN & JANET Y	840 LARNED LN	Modesto CA 95357	\$26.00
079-004-027-000	BARTON KEVIN A	836 LARNED LN	Modesto CA 95357	\$26.00
079-004-028-000	SEN INDAR & SEN SURUJ M	832 LARNED LN	Modesto CA 95357	\$26.00
079-004-029-000	VIGIL CELSO ET AL	828 LARNED LN	Modesto CA 95357	\$26.00
079-004-030-000	MENDOZA GEORGINA	3925 SHARPSBURG DR	Modesto CA 95357	\$26.00
079-004-031-000	VEGA CESAR & SABRINA	3921 SHARPSBURG DR	Modesto CA 95357	\$26.00
079-004-032-000	BALANJII HELEN FARHAD ZADEH	3917 SHARPSBURG DR	Modesto CA 95357	\$26.00
079-004-033-000	GLEN MAVIS J TR	3913 SHARPSBURG DR	Modesto CA 95357	\$26.00
079-004-034-000	SAN PEDRO SHIRLEY Q & GEORGE	3909 SHARPSBURG DR	Modesto CA 95357	\$26.00

Fee Parcel	Owner	Address	City State Zip	2022-23 Ast.
079-004-035-000	COGBURN LATISHA	3905 SHARPSBURG DR	Modesto CA 95357	\$26.00
079-004-036-000	PHIPPS CORY L & PHIPPS CAROLE J	3901 SHARPSBURG DR	Modesto CA 95357	\$26.00
079-004-037-000	RAYA ARMANDO & ESPARZA JOAN	3821 SHARPSBURG DR	Modesto CA 95357	\$26.00
079-004-038-000	BARNETT BRIENT K & ERIN	3817 SHARPSBURG DR	Modesto CA 95357	\$26.00
079-004-039-000	MUNOZFERRER ISMAEL & GLORIA LETICIA	3813 SHARPSBURG DR	Modesto CA 95357	\$26.00
079-004-040-000	AU-YEUNG CHI & AU-YEUNG TZE H	3809 SHARPSBURG DR	Modesto CA 95357	\$26.00
079-004-041-000	VASQUEZ CODY R & BYIANCA	3805 SHARPSBURG DR	Modesto CA 95351	\$26.00
079-004-042-000	SERNA MARLA ANN TR	3801 SHARPSBURG DR	Modesto CA 95357	\$26.00
079-004-043-000	SOUZA RICK L & SOUZA MARVELYN	3721 SHARPSBURG DR	Modesto CA 95357	\$26.00
079-004-044-000	WOOD SHAWN & WOOD KRISTINA M	3717 SHARPSBURG DR	Modesto CA 95357	\$26.00
079-004-045-000	HARO SAYRA YOSELYNE GUTIERREZ ET AL	3713 SHARPSBURG DR	Modesto CA 95357	\$26.00
079-004-046-000	OROZCO RUDY JOSEPH & QUIRALTE-CASTANEDA MELISSA	3709 SHARPSBURG DR	Modesto CA 95357	\$26.00
079-004-047-000	DIVIRD HEIDI N & JASON R	3705 SHARPSBURG DR	Modesto CA 95354	\$26.00
079-004-048-000	PANG YIM PING & LI FELIX JING HUI	3701 SHARPSBURG DR	Modesto CA 09535	\$26.00
079-004-049-000	EYRING MARION L TR	3712 WICHITA WAY	Modesto CA 95357	\$26.00
079-004-050-000	BENTLEY DOUGLAS & BENTLEY LEEANNE K	3716 WICHITA WAY	Modesto CA 95357	\$26.00
079-004-051-000	LEYVA RENE SR & CLAUDIA D	3720 WICHITA WAY	Modesto CA 95357	\$26.00
079-004-052-000	DUMAS JAMES BRIAN SR & PAMELA LEE TRS	3724 WICHITA WAY	Modesto CA 95357	\$26.00
079-004-053-000	MORENO ROSA MARIA	3728 WICHITA WAY	Modesto CA 95354	\$26.00
079-004-054-000	GALVAN OLALDE DANIEL GIBRAN & DIAZ GALVAN LAURA EL	3732 WICHITA WAY	Modesto CA 95357	\$26.00
079-004-055-000	CASTILLO RAFAEL	3800 WICHITA WAY	Modesto CA 95357	\$26.00
079-004-056-000	SALVATION ARMY	3804 WICHITA WAY	Modesto CA 95357	\$26.00
079-004-057-000	CLINE DAVID L & DEBRA N TRS	3808 WICHITA WAY	Modesto CA 95357	\$26.00
079-004-058-000	FUGATE BRANDON ET AL TRS	3812 WICHITA WAY	Modesto CA 95357	\$26.00
079-004-059-000	FLORES ROSANA P & JUANITO S JR	3816 WICHITA WAY	Modesto CA 95357	\$26.00
079-004-060-000	CABEBE MARIA RIZALINA C TR	3820 WICHITA WAY	Modesto CA 95357	\$26.00
079-004-061-000	MAYOL BIRGITT A TR ET AL	3824 WICHITA WAY	Modesto CA 95357	\$26.00
079-004-062-000	BADILLO ALAN & ADELITA M	3828 WICHITA WAY	Modesto CA 95357	\$26.00
079-004-063-000	VU DINH DUC	3900 WICHITA WAY	Modesto CA 95357	\$26.00
079-004-064-000	ALVAREZ LOUIS L ET AL	3904 WICHITA WAY	Modesto CA 95357	\$26.00
079-004-065-000	MANCINI JUDITH	3908 WICHITA WAY	Modesto CA 95357	\$26.00
079-004-066-000	ISRAEL SAMMY S & SHERLY ESGUERRA	3912 WICHITA WAY	Modesto CA 95357	\$26.00
079-004-067-000	ROJAS ROGELIO A	3916 WICHITA WAY	Modesto CA 95354	\$26.00
079-004-068-000	OVIEDO IRMA L ET AL	3920 WICHITA WAY	Modesto CA 95357	\$26.00
079-004-069-000	OKEY LEOTA L TR	3924 WICHITA WAY	Modesto CA 95357	\$26.00
079-005-001-000	SIMPSON STEVEN	732 SPINDALE DR	Modesto CA 95357	\$26.00
079-005-002-000	BALLIET RICHARD L & BALLIET SHERRY	736 SPINDALE DR	Modesto CA 95357	\$26.00
079-005-003-000	STAATS BAMBI MICHELLE ET AL	800 SALINA DR	Modesto CA 95357	\$26.00
079-005-004-000	HELLERUD GARRY A & HELLERUD ARLENE L	804 SALINA DR	Modesto CA 95354	\$26.00
079-005-005-000	URENA FIDEL & ELIA K	813 PARSONS CT	Modesto CA 95354	\$26.00
079-005-006-000	CLEMENTS PANDORA A	809 PARSONS CT	Modesto CA 95357	\$26.00
079-005-007-000	THOMPSON MELANIE	805 PARSONS CT	Modesto CA 95357	\$26.00
079-005-008-000	LAKE DAVID E & LAKE MARGARET R	800 PARSONS CT	Modesto CA 95357	\$26.00
079-005-009-000	LEE EDMUND W TR	804 PARSONS CT	Modesto CA 95357	\$26.00
079-005-010-000	GARCIA EDUARDO CAMPOS & ELIZABETH AGUARISTI TRS	808 PARSONS CT	Modesto CA 95351	\$26.00
079-005-011-000	HINOJOS BRANDON & KRYSTAL R	812 PARSONS CT	Modesto CA 95357	\$26.00
079-005-012-000	RANGEL FRANCISCO JAVIER JR	817 LEAVENWORTH WAY	Modesto CA 95357	\$26.00
079-005-013-000	MEDINA VICTOR & IRMA	813 LEAVENWORTH WAY	Modesto CA 95357	\$26.00
079-005-014-000	FAGUNDES ANTONIO L & HAIR JACQUELINE K TRS	809 LEAVENWORTH WAY	Modesto CA 95357	\$26.00
079-005-015-000	GARCIA MATIAS & GARCIA MERCEDES	805 LEAVENWORTH WAY	Modesto CA 95357	\$26.00
079-005-016-000	ERWIN TERESA M	801 LEAVENWORTH WAY	Modesto CA 95357	\$26.00
079-005-017-000	OWENS LARRY G & MARY Z TRS	800 LEAVENWORTH WAY	Modesto CA 95351	\$26.00
079-005-018-000	TAYLOR BRADLEY JOSEPH	804 LEAVENWORTH WAY	Modesto CA 95357	\$26.00
079-005-019-000	BISHOFF PHYLLIS J TR	808 LEAVENWORTH WAY	Modesto CA 95357	\$26.00
079-005-020-000	GASPARYAN ARMEN ET AL	812 LEAVENWORTH WAY	Modesto CA 95357	\$26.00

Fee Parcel	Owner	Address	City State Zip	2022-23 Ast.
079-005-021-000	MARCELINO DAVID C & REBECCA N	816 LEAVENWORTH WAY	Modesto CA 95357	\$26.00
079-005-022-000	GONZALES LOUIS R SR	3908 SHARPSBURG DR	Modesto CA 95357	\$26.00
079-005-023-000	DAVISON WAYNE & JO	3912 SHARPSBURG DR	Modesto CA 95357	\$26.00
079-005-024-000	HAWIL ALFRED	3916 SHARPSBURG DR	Modesto CA 95357	\$26.00
079-005-025-000	DURHAM SANDY M	817 LARNED LN	Modesto CA 95357	\$26.00
079-005-026-000	MCCARTHY JAMES & TAMRA	813 LARNED LN	Modesto CA 95357	\$26.00
079-005-027-000	CHEN GEORGE CHONG JYH & HOLLY YUN YAN	809 LARNED LN	Modesto CA 95357	\$26.00
079-005-028-000	VAN DIEMEN MICHAEL B & VAN DIEMEN LAURI L	805 LARNED LN	Modesto CA 95357	\$26.00
079-005-029-000	LIGHT MARK T & WRIGHT LUCILA	3909 GOODLAND CT	Modesto CA 95357	\$26.00
079-005-030-000	LUCAS THOMAS M III & LUCAS LISA M	3905 GOODLAND CT	Modesto CA 95357	\$26.00
079-005-031-000	BARKLEY JOSEPH E TR	3900 GOODLAND CT	Modesto CA 95357	\$26.00
079-005-032-000	BROOKS CHARLES A & SUSAN D TRS	3904 GOODLAND CT	Modesto CA 95357	\$26.00
079-005-033-000	GAMBOA BENITO & ANGELICA	3908 GOODLAND CT	Modesto CA 95357	\$26.00
079-005-034-000	MORALES SHARON & LUIS	3912 GOODLAND CT	Modesto CA 95357	\$26.00
079-005-035-000	YOUNGER ROGER COLEMAN & LAURA JEAN TRS	3916 GOODLAND CT	Modesto CA 95357	\$26.00
079-005-036-000	COLE TINA M	3920 GOODLAND CT	Modesto CA 95357	\$26.00
079-005-037-000	ALVARADO MARIA D	800 LARNED LN	Modesto CA 95357	\$26.00
079-005-038-000	PALMERIN JOSE DE JESUS	804 LARNED LN	Modesto CA 95357	\$26.00
079-005-039-000	NUNEZ OMAR AYON	808 LARNED LN	Modesto CA 95357	\$26.00
079-005-040-000	AZUETA ORLANDO & ALAVAREZ LAURA CISNEROS	812 LARNED LN	Modesto CA 95357	\$26.00
079-005-041-000	CAMARENA JESUS D ET AL	816 LARNED LN	Modesto CA 95357	\$26.00
079-005-042-000	MORAD EDMOND & MORAD CARMEN	820 LARNED LN	Modesto CA 95357	\$26.00
079-005-043-000	BROWN DANNY ARTHUR & CHRISTINA	824 LARNED LN	Modesto CA 95357	\$26.00
079-006-001-000	SARETH JESSIE ET AL	737 WADDELL WAY	Modesto CA 95357	\$26.00
079-006-002-000	NASSER MOHAMED	741 WADDELL WAY	Modesto CA 95357	\$26.00
079-006-003-000	TORRES ANTHONY RENE JR ET AL	745 WADDELL WAY	Modesto CA 95357	\$26.00
079-006-004-000	CHHIM LIM	749 WADDELL WAY	Modesto CA 95357	\$26.00
079-006-005-000	FLORES J JESUS	753 WADDELL WAY	Modesto CA 95357	\$26.00
079-006-006-000	SAMOW HALA	757 WADDELL WAY	Modesto CA 95357	\$26.00
079-006-007-000	MICHAEL RAPHAEL ET AL	761 WADDELL WAY	Modesto CA 95357	\$26.00
079-006-008-000	REYES JIM R & REYES ELLEN S	765 WADDELL WAY	Modesto CA 95357	\$26.00
079-006-010-000	JOHNSON GERALD L ET AL	752 CODINGTON WAY	Modesto CA 95357	\$26.00
079-006-011-000	FELICIANO LIORITA A & RUSEL C	748 CODINGTON WAY	Modesto CA 95357	\$26.00
079-006-012-000	WEBB LAQUITA	744 CODINGTON WAY	Modesto CA 95357	\$26.00
079-006-013-000	GARCIA FRANCISCO & YOLANDA	740 CODINGTON WAY	Modesto CA 95357	\$26.00
079-006-014-000	MC CRARY MARY JANE	736 CODINGTON WAY	Modesto CA 95357	\$26.00
079-006-015-000	CHAVEZ ALEJANDRO PACHECO	732 CODINGTON WAY	Modesto CA 95357	\$26.00
079-006-016-000	TELLEZ MAURICE R & MARGARITA F	728 CODINGTON WAY	Modesto CA 95357	\$26.00
079-006-017-000	TELLEZ MAURICE R & MARGARITA F	724 CODINGTON WAY	Modesto CA 95357	\$26.00
079-006-018-000	SANTOS LUZ MARIA	720 CODINGTON WAY	Modesto CA 95357	\$26.00
079-006-019-000	SANTOS LUZ	716 CODINGTON WAY	Modesto CA 95357	\$26.00
079-006-020-000	PADILLA SALVADOR & PADILLA ANTONIA	712 CODINGTON WAY	Modesto CA 95357	\$26.00
079-006-021-000	PERROTTI PATRICK ET AL TRS	708 CODINGTON WAY	Modesto CA 95357	\$26.00
079-006-022-000	BAINS GURNAM S & BALVINDER K	704 CODINGTON WAY	Modesto CA 95355	\$26.00
079-006-023-000	LOTKO ANN E	700 CODINGTON WAY	Modesto CA 95357	\$26.00
079-006-024-000	PEREZ JUAN & SILVIA P TRS	640 CODINGTON WAY	Modesto CA 95357	\$26.00
079-006-025-000	RAM RAVI PRAKASH & RAM SANJILA PRAKASH	701 CODINGTON WAY	Modesto CA 95357	\$26.00
079-006-026-000	BANUELOS MARTHA E TR	705 CODINGTON WAY	Modesto CA 95357	\$26.00
079-006-027-000	ARROYO RAFAEL ARROYO & CHAVEZ GUADALUPE RAMIREZ	709 CODINGTON WAY	Modesto CA 95357	\$26.00
079-006-028-000	BENDERAS DAMARA	713 CODINGTON WAY	Modesto CA 95357	\$26.00
079-006-029-000	AGUIRRE ALICIA R	717 CODINGTON WAY	Modesto CA 95357	\$26.00
079-006-030-000	GOMEZ FRANCISCO J & PATRICIA	721 CODINGTON WAY	Modesto CA 95357	\$26.00
079-006-031-000	BAINS GURNAM S & BALVINDER K	725 CODINGTON WAY	Modesto CA 95357	\$26.00
079-006-032-000	FIGUEROA LUIS E & FIGUEROA ISABEL L	729 CODINGTON WAY	Modesto CA 95357	\$26.00
079-006-033-000	CARROLL EDWIN JOSEPH II & LEPE-CARROLL CONNIE LEA	733 CODINGTON WAY	Modesto CA 95357	\$26.00

Fee Parcel	Owner	Address	City State Zip	2022-23 Ast.
079-006-034-000	AMBROSICH STEPHEN F TR	737 CODINGTON WAY	Modesto CA 95357	\$26.00
079-006-035-000	MOLINA GIOVANI & ORTEGA MARIA ESTHER TALAVERA	741 CODINGTON WAY	Modesto CA 95357	\$26.00
079-006-036-000	GALE MARK D II & DEBRA L TRS	745 CODINGTON WAY	Modesto CA 95354	\$26.00
079-006-037-000	SILLEMONT ANTHONY	749 CODINGTON WAY	Modesto CA 95357	\$26.00
079-006-038-000	GUZMAN JESUS A	744 CARRBORO LN	Modesto CA 95357	\$26.00
079-006-039-000	LOUCKS DAVID GEORGE & JOSEFA M TRS	740 CARRBORO LN	Modesto CA 95357	\$26.00
079-006-040-000	PATRICK ANTONIO	736 CARRBORO LN	Modesto CA 95357	\$26.00
079-006-041-000	PALOMERA HECTOR MANUEL	732 CARRBORO LN	Modesto CA 95357	\$26.00
079-006-042-000	WILLIAMS MARLON & NENA	728 CARRBORO LN	Modesto CA 95357	\$26.00
079-006-043-000	DEBERRY GARY L & ALICE	724 CARRBORO LN	Modesto CA 95357	\$26.00
079-006-044-000	LAMPROE LEONARD C & LAMPROE MARY A	720 CARRBORO LN	Modesto CA 95357	\$26.00
079-006-045-000	GARCIA FELIPE & FLORES BLANCA	716 CARRBORO LN	Modesto CA 95357	\$26.00
079-006-046-000	ODISHO DAVID & ODISHO JULIET	712 CARRBORO LN	Modesto CA 95357	\$26.00
079-006-047-000	LI ZHIHE & HUANG LIFEI	708 CARRBORO LN	Modesto CA 95357	\$26.00
079-006-048-000	DAVID VIRGEEN	704 CARRBORO LN	Modesto CA 95357	\$26.00
079-006-049-000	CONN HILARY A & GARY	700 CARRBORO LN	Modesto CA 95357	\$26.00
079-007-001-000	CHOW MINH LU ET AL	729 WADDELL WAY	Modesto CA 95354	\$26.00
079-007-002-000	JORGENSEN FRANK E & MIRIAM M TRS	725 WADDELL WAY	Modesto CA 95357	\$26.00
079-007-003-000	GASPAR JENNIFER L	721 WADDELL WAY	Modesto CA 95357	\$26.00
079-007-004-000	PENALOSA FABIAN HERNANDEZ	717 WADDELL WAY	Modesto CA 95357	\$26.00
079-007-005-000	L & D RENTALS LLC	713 WADDELL WAY	Modesto CA 95357	\$26.00
079-007-006-000	GUTIERREZ DIEGO	709 WADDELL WAY	Modesto CA 95357	\$26.00
079-007-007-000	SHANDIL SHALESH & IRENE R	705 WADDELL WAY	Modesto CA 95357	\$26.00
079-007-008-000	MC CLURE JODI PENIRIAN	701 WADDELL WAY	Modesto CA 95357	\$26.00
079-007-009-000	FERNANDEZ RAMIRO & ALMA	669 WADDELL WAY	Modesto CA 95357	\$26.00
079-007-010-000	ZAMORA GUILLERMO	665 WADDELL WAY	Modesto CA 95357	\$26.00
079-007-011-000	STOLLBERG WILLIAM R & HOAI TRS	661 WADDELL WAY	Modesto CA 95354	\$26.00
079-007-012-000	L & D RENTALS LLC	657 WADDELL WAY	Modesto CA 95357	\$26.00
079-007-013-000	BAINS KABAL S & JASBIR K	653 WADDELL WAY	Modesto CA 95357	\$26.00
079-007-014-000	BAKER OUTIN MARLENE	649 WADDELL WAY	Modesto CA 95357	\$26.00
079-007-015-000	MARSELLA BARBARA A	645 WADDELL WAY	Modesto CA 95357	\$26.00
079-007-016-000	ROQUE DARWIN ET AL	641 WADDELL WAY	Modesto CA 95357	\$26.00
079-007-017-000	RUIZ IGNACIO VASQUEZ ET AL	648 WADDELL WAY	Modesto CA 95357	\$26.00
079-007-018-000	HANSON LARRY P & DORA	652 WADDELL WAY	Modesto CA 95357	\$26.00
079-007-019-000	MENDEZ HILARIO	656 WADDELL WAY	Modesto CA 95350	\$26.00
079-007-020-000	AMBRIZ MARIO G	721 RIEDSVILLE CT	Modesto CA 95357	\$26.00
079-007-021-000	SMITH SCOTT ROYAL TR	717 RIEDSVILLE CT	Modesto CA 95354	\$26.00
079-007-022-000	ZAVALA JOHN & YVONNE	713 RIEDSVILLE CT	Modesto CA 95357	\$26.00
079-007-023-000	ACOSTA DAVID ET AL	716 RIEDSVILLE CT	Modesto CA 95357	\$26.00
079-007-024-000	SCHULTZ BRENDA J & RONALD	720 RIEDSVILLE CT	Modesto CA 95357	\$26.00
079-007-025-000	RIVERA RAMON ET AL	712 WADDELL WAY	Modesto CA 95357	\$26.00
079-007-026-000	PALMERIN ERNESTO & MARIA	716 WADDELL WAY	Modesto CA 95357	\$26.00
079-007-027-000	MOLES EDWARD A & DIAMOND SUSAN H TRS	720 WADDELL WAY	Modesto CA 95357	\$26.00
079-007-028-000	SOTO ANABEL	724 WADDELL WAY	Modesto CA 95357	\$26.00
079-007-029-000	TRIMBLE BRENDA E	728 WADDELL WAY	Modesto CA 95354	\$26.00
079-007-030-000	POZZOULI JOHN L	732 WADDELL WAY	Modesto CA 95357	\$26.00
079-007-031-000	SINGH SURUJ B & SINGH LACHMI BAI	736 WADDELL WAY	Modesto CA 95357	\$26.00
079-007-032-000	DE LA TORRE CONRADO & ROSEMARY TRS	740 WADDELL WAY	Modesto CA 95357	\$26.00
079-007-033-000	MARCIANO ARMANDO D & MARCIANO REMEDIOS R	737 CARRBORO LN	Modesto CA 95357	\$26.00
079-007-034-000	PLACE GREGORY & SHERI L	733 CARRBORO LN	Modesto CA 95357	\$26.00
079-007-035-000	MECIA MIGUEL A & ASPEN	729 CARRBORO LN	Modesto CA 95357	\$26.00
079-007-036-000	ZUNIGA ANDRES PEREZ & GARCIA LIZETH L	725 CARRBORO LN	Modesto CA 95357	\$26.00
079-007-037-000	CEJA BEATRICE	721 CARRBORO LN	Modesto CA 95357	\$26.00
079-007-038-000	GONZALES ELBA CRISTINA	717 CARRBORO LN	Modesto CA 95357	\$26.00
079-007-039-000	HARRISON KAREN S	713 CARRBORO LN	Modesto CA 95357	\$26.00

Fee Parcel	Owner	Address	City State Zip	2022-23 Ast.
079-007-040-000	VILLALOVOS ART ROBERT & YOLANDA	709 CARRBORO LN	Modesto CA 95357	\$26.00
079-007-041-000	HARPER MICHAEL P & LILLIE M	700 CHADBURN CT	Modesto CA 95357	\$26.00
079-007-042-000	JACKSON JONATHAN & ADONA	704 CHADBURN CT	Modesto CA 95357	\$26.00
079-007-043-000	DIAS JEREMIAH A ET AL	708 CHADBURN CT	Modesto CA 95357	\$26.00
079-007-044-000	SAMRA GURDIP & PREET	712 CHADBURN CT	Modesto CA 95357	\$26.00
079-007-045-000	ROBLES RICHELLE & YULO JOHN	716 CHADBURN CT	Modesto CA 95357	\$26.00
079-007-046-000	MEZA JACQUELINE M	720 CHADBURN CT	Modesto CA 95354	\$26.00
079-007-047-000	TRUESDAIL SHELBY J	724 CHADBURN CT	Modesto CA 95357	\$26.00
079-007-048-000	BAHI EILEEN	721 CHADBURN CT	Modesto CA 95354	\$26.00
079-007-049-000	IBARRA JUANA	717 CHADBURN CT	Modesto CA 95357	\$26.00
079-007-050-000	YEFREMENKO ALEKSEY & CANDICE	713 CHADBURN CT	Modesto CA 95357	\$26.00
079-007-051-000	ROJAS VICENTE ET AL	709 CHADBURN CT	Modesto CA 95357	\$26.00
079-007-052-000	ESTRADA-GAMBOA RAMON	705 CHADBURN CT	Modesto CA 95355	\$26.00
079-007-053-000	SILVEIRA FERNANDA	3725 CREEDMOOR AVE	Modesto CA 95357	\$26.00
079-007-054-000	LUTZOW JOHN P	3721 CREEDMOOR AVE	Modesto CA 95357	\$26.00
079-007-055-000	PEREZ JOSE P & PEREZ ROSA M	3717 CREEDMOOR AVE	Modesto CA 95357	\$26.00
079-007-056-000	SKOCHKO KATHLEEN A & SKOCHKO RICHARD A	3713 CREEDMOOR AVE	Modesto CA 95357	\$26.00
079-007-057-000	DAVIS JAMES R & DAVIS LETECIA B	3709 CREEDMOOR AVE	Modesto CA 95354	\$26.00
079-008-001-000	BUAYA DAVID TR	620 N MC CLURE RD	Modesto CA 95357	\$26.00
079-008-002-000	ALI SYED ARIF & ARIF SHAZIA	616 N MC CLURE RD	Modesto CA 95357	\$26.00
079-008-003-000	CONCHAS SANDRA H	612 N MC CLURE RD	Modesto CA 95356	\$26.00
079-008-004-000	RENO FRED W	608 N MC CLURE RD	Modesto CA 95354	\$26.00
079-008-005-000	CHAND VIJAY & MATI SOHAN	604 N MC CLURE RD	Modesto CA 95354	\$26.00
079-008-006-000	CHAND VIJAY V ET AL	600 N MC CLURE RD	Modesto CA 95357	\$26.00
079-008-007-000	JACKSON MATTHEW & JACKSON SUZANNA	564 N MC CLURE RD	Modesto CA 95357	\$26.00
079-008-008-000	WARD DONALD G & CARLILE-WARD CARRIE LYNN	560 N MC CLURE RD	Modesto CA 95354	\$26.00
079-008-009-000	MOUNDI HARINDER K & GURDIAL SINGH W	556 N MC CLURE RD	Modesto CA 95354	\$26.00
079-008-010-000	BORGES FRANK J	552 N MC CLURE RD	Modesto CA 95357	\$26.00
079-008-011-000	MILLER THOMAS H TR	548 N MC CLURE RD	Modesto CA 95357	\$26.00
079-008-012-000	PRASAD DHARMEND	544 N MC CLURE RD	Modesto CA 95357	\$26.00
079-008-013-000	MAHARAJ ARUNA & SANJAI S	540 N MC CLURE RD	Modesto CA 95357	\$26.00
079-008-014-000	TAGRE ABEL JOSE & TERRIE MARIE TRS	536 N MC CLURE RD	Modesto CA 95357	\$26.00
079-008-015-000	RODRIGUEZ ROBERTA L & GUILLEN OSCAR J	501 REDFIELD AVE	Modesto CA 95357	\$26.00
079-008-016-000	SABLOK SATISH KUMAR & RENUKA TRS	505 REDFIELD AVE	Modesto CA 95357	\$26.00
079-008-017-000	PEEK CHARLES & PEEK ADRIENNE	509 REDFIELD AVE	Modesto CA 95357	\$26.00
079-008-018-000	KINCHELOE KAREN TR	513 REDFIELD AVE	Modesto CA 95357	\$26.00
079-008-019-000	SHARMA UMA L	517 REDFIELD AVE	Modesto CA 95357	\$26.00
079-008-020-000	CARDOSO JOHN P	521 REDFIELD AVE	Modesto CA 95357	\$26.00
079-008-021-000	BATES SEAN & LAURA	525 REDFIELD AVE	Modesto CA 95357	\$26.00
079-008-022-000	ZERMENO RAUL R & MARIA LETICIA TRS	529 REDFIELD AVE	Modesto CA 95357	\$26.00
079-008-023-000	ZARAGOZA RICARDO	533 REDFIELD AVE	Modesto CA 95357	\$26.00
079-008-024-000	MONTGOMERY KENNITHA	601 REDFIELD AVE	Modesto CA 95357	\$26.00
079-008-025-000	JEET JERMY S	605 REDFIELD AVE	Modesto CA 95357	\$26.00
079-008-026-000	BROWER PROPERTIES 3 LLC	609 REDFIELD AVE	Modesto CA 95357	\$26.00
079-008-027-000	KUMAR PRANEEL	613 REDFIELD AVE	Modesto CA 95357	\$26.00
079-008-028-000	CV RESIDENTIAL LLC	617 REDFIELD AVE	Modesto CA 95357	\$26.00
079-008-029-000	PRAK DEBBIE & MANANQUIL DEXTER	3516 DRY CREEK DR	Modesto CA 95357	\$26.00
079-008-030-000	BROWN CAROL C TR	3520 DRY CREEK DR	Modesto CA 95357	\$26.00
079-008-031-000	WRIGHT JACQUELINE L TR	3524 DRY CREEK DR	Modesto CA 95354	\$26.00
079-008-032-000	HARDY RICK L & LYNN P	3528 DRY CREEK DR	Modesto CA 95357	\$26.00
079-008-033-000	VEGA DANIEL	3532 DRY CREEK DR	Modesto CA 95357	\$26.00
079-008-034-000	CARRILLO OLIVIA ET AL	3536 DRY CREEK DR	Modesto CA 95357	\$26.00
079-008-035-000	SINGH KULDIP & KOUR JASBIR	3600 DRY CREEK DR	Modesto CA 95357	\$26.00
079-008-036-000	MENDOZA RAFAEL ROSALES	3604 DRY CREEK DR	Modesto CA 95357	\$26.00
079-008-037-000	ORTIZ MATIAS & ORTIZ JOSEFINA	3608 DRY CREEK DR	Modesto CA 95357	\$26.00

Fee Parcel	Owner	Address	City State Zip	2022-23 Ast.
079-008-038-000	BROWN DALE LEE & VANESSA MARIE	3612 DRY CREEK DR	Modesto CA 95357	\$26.00
079-008-039-000	NEY GARY III	3616 DRY CREEK DR	Modesto CA 95357	\$26.00
079-008-040-000	ECKLES ROBERT S & ECKLES JULIE L	3620 DRY CREEK DR	Modesto CA 95357	\$26.00
079-008-041-000	SINGH SHALVIN V & SEN ADREEN JYOTISH	3624 DRY CREEK DR	Modesto CA 95357	\$26.00
079-008-042-000	MALLEY KATHERINE S	3628 DRY CREEK DR	Modesto CA 95357	\$26.00
079-008-043-000	KELLER ALFRED W	3632 DRY CREEK DR	Modesto CA 95357	\$26.00
079-008-044-000	DAVIS LUELLA B & DAVIS WAYNE W	3636 DRY CREEK DR	Modesto CA 95357	\$26.00
079-008-045-000	HERNANDEZ FRANK J & DIANA C	3640 DRY CREEK DR	Modesto CA 95357	\$26.00
079-008-046-000	STAMPS GENE A & GLORIA M	532 WILMONT LN	Modesto CA 95357	\$26.00
079-008-047-000	JIMENEZ GERARDO	536 WILMONT LN	Modesto CA 95357	\$26.00
079-008-048-000	MATULIS ERIC A	3633 HIGHMORE LN	Modesto CA 95357	\$26.00
079-008-049-000	CHIU JOSEPH CHI TSUN & LEE HELEN LAI TRS	3629 HIGHMORE LN	Modesto CA 95357	\$26.00
079-008-050-000	FARA AHMED & FARA MUFDHLA	3625 HIGHMORE LN	Modesto CA 95357	\$26.00
079-008-051-000	JAUREGUI HORACIO J & SUSANA	3621 HIGHMORE LN	Modesto CA 95357	\$26.00
079-008-052-000	CISNEROS MARTIN T & CISNEROS MELISSA	3617 HIGHMORE LN	Modesto CA 95357	\$26.00
079-008-053-000	SINGH PREM	3613 HIGHMORE LN	Modesto CA 95357	\$26.00
079-008-054-000	WHITAKER SAUDIA F	3609 HIGHMORE LN	Modesto CA 95357	\$26.00
079-008-055-000	PRASAD JACK J & RESHMA D	3605 HIGHMORE LN	Modesto CA 95357	\$26.00
079-008-056-000	GUTIERREZ JESUS & MARIA DE JESUS	3601 HIGHMORE LN	Modesto CA 95357	\$26.00
079-008-057-000	VELAZQUEZ MANUEL D JR & ELENA	3533 HIGHMORE LN	Modesto CA 95357	\$26.00
079-008-058-000	POSLANIEC COBY L	3529 HIGHMORE LN	Modesto CA 95357	\$26.00
079-008-059-000	SADA FRED & JACKIE H	3525 HIGHMORE LN	Modesto CA 95357	\$26.00
079-008-060-000	MEDINA ROBERTO LEON & MARIA DE LOS ANGELES TRS	3521 HIGHMORE LN	Modesto CA 95357	\$26.00
079-008-061-000	AVILA ELISEO G ET AL	3517 HIGHMORE LN	Modesto CA 95357	\$26.00
079-008-062-000	KAUR NAVDEEP & SINGH DALVIR	3513 HIGHMORE LN	Modesto CA 95357	\$26.00
079-009-003-000	MARTINEZ CRYSTAL TR	3629 ARDIA AVE	Modesto CA 95357	\$26.00
079-009-004-000	POK NAVEEN & VEULVILAVONG AMMONE	3625 ARDIA AVE	Modesto CA 95353	\$26.00
079-009-005-000	WRIGHT ROBERT T TR	3621 ARDIA AVE	Modesto CA 95357	\$26.00
079-009-006-000	DALMAN NINON M	3617 ARDIA AVE	Modesto CA 95357	\$26.00
079-009-007-000	VARGAS ROBERT S & MARTHA V	3613 ARDIA AVE	Modesto CA 95357	\$26.00
079-009-008-000	RUSH ROBERT P SR & PATRICIA L	3609 ARDIA AVE	Modesto CA 95357	\$26.00
079-009-009-000	CICCONI LEANN	3605 ARDIA AVE	Modesto CA 95357	\$26.00
079-009-010-000	CAMBA JOSEPH	3601 ARDIA AVE	Modesto CA 95357	\$26.00
079-009-011-000	NAIRN DENNIS & REBECCA	3533 ARDIA AVE	Modesto CA 95357	\$26.00
079-009-012-000	MONDRAGON LUIS JR	3529 ARDIA AVE	Modesto CA 95357	\$26.00
079-009-013-000	JOHAL SUKHWINDER KAUR & JASBIR S SINGH	3525 ARDIA AVE	Modesto CA 95357	\$26.00
079-009-014-000	THANDI H S & S K	3521 ARDIA AVE	Modesto CA 95357	\$26.00
079-009-015-000	RAMOS FERNANDO A & MONSELLE TESSA JANINE	3517 ARDIA AVE	Modesto CA 95357	\$26.00
079-009-016-000	MARTINEZ TONY R JR	3513 ARDIA AVE	Modesto CA 95357	\$26.00
079-009-017-000	FIGUEROA JASMINE E	3512 BALFOUR LN	Modesto CA 95357	\$26.00
079-009-018-000	GREWAL JASKIRAN	3516 BALFOUR LN	Modesto CA 95357	\$26.00
079-009-019-000	OGDEN ROBERT C & DEBORAH A TRS	3520 BALFOUR LN	Modesto CA 95357	\$26.00
079-009-020-000	FOUNTAIN TIMOTHY J & FOUNTAIN DEBORAH A	3524 BALFOUR LN	Modesto CA 95357	\$26.00
079-009-021-000	TOBON LAURO I CORTES & CORTES MARY CARMEN	3528 BALFOUR LN	Modesto CA 95357	\$26.00
079-009-022-000	COLLS LUIS R TR	3600 BALFOUR LN	Modesto CA 95357	\$26.00
079-009-023-000	MANRIQUEZ UBALDO & DORA	3604 BALFOUR LN	Modesto CA 95357	\$26.00
079-009-024-000	AMEREL CLEVE & ROSA	3608 BALFOUR LN	Modesto CA 95357	\$26.00
079-009-025-000	JOHNSON SOUNITA ET AL	3612 BALFOUR LN	Modesto CA 95354	\$26.00
079-009-026-000	LEWMAN-KUNKLER BRENDA F TR	3616 BALFOUR LN	Modesto CA 95357	\$26.00
079-009-027-000	LEE DAVID S & HU YANTING	3620 BALFOUR LN	Modesto CA 95357	\$26.00
079-009-028-000	GONZALEZ ALFONSO CHAVEZ & RAMPONI-CHAVEZ JUDY	3624 BALFOUR LN	Modesto CA 95357	\$26.00
079-009-029-000	SANCHEZ HUGO & ZENAIDA	3628 BALFOUR LN	Modesto CA 95357	\$26.00
079-009-030-000	TOMLINSON MARK S & TOMLINSON JENNIFER D	3632 BALFOUR LN	Modesto CA 95357	\$26.00
079-009-031-000	GOVEA PETER C & CAROL M TRS	512 WILMONT LN	Modesto CA 95357	\$26.00
079-009-032-000	CERVANTES JUAN MANUEL OCEGUERA & CASILLAS ROCIO	516 WILMONT LN	Modesto CA 95357	\$26.00

Fee Parcel	Owner	Address	City State Zip	2022-23 Ast.
	ME			
079-009-033-000	KHOURY TANIA SALIBA	520 WILMONT LN	Modesto CA 95351	\$26.00
079-009-034-000	BARRY MAGED	524 WILMONT LN	Modesto CA 95355	\$26.00
079-009-035-000	BIZZINI KELLY A	528 WILMONT LN	Modesto CA 95357	\$26.00
079-009-036-000	MARTINEZ PEDRO & HERNANDEZ APRIL	3628 HIGHMORE LN	Modesto CA 95357	\$26.00
079-009-037-000	RAMIREZ JESUS ET AL	3624 HIGHMORE LN	Modesto CA 95357	\$26.00
079-009-038-000	CERDA CENDEJAS GONZALO ET AL	3620 HIGHMORE LN	Modesto CA 95357	\$26.00
079-009-039-000	WILHELM DENNIS & WILHELM JANICE	3616 HIGHMORE LN	Modesto CA 95357	\$26.00
079-009-040-000	CASTRO MARIA	3612 HIGHMORE LN	Modesto CA 95357	\$26.00
079-009-041-000	VIZCARRA JOSE A	3608 HIGHMORE LN	Modesto CA 95357	\$26.00
079-009-042-000	FERREZ LIDIA E ET AL	3604 HIGHMORE LN	Modesto CA 95357	\$26.00
079-009-043-000	ZAYA SAMIA	3600 HIGHMORE LN	Modesto CA 95354	\$26.00
079-009-044-000	CHIU CHARLES	3528 HIGHMORE LN	Modesto CA 95357	\$26.00
079-009-045-000	FORBES DEENA M ET AL	3524 HIGHMORE LN	Modesto CA 95357	\$26.00
079-009-046-000	LITTMANN PETER & TAMARA	3520 HIGHMORE LN	Modesto CA 95355	\$26.00
079-009-047-000	MANI LOGESH & SADHANA	3516 HIGHMORE LN	Modesto CA 95357	\$26.00
079-009-048-000	KUMAR KAMIL ET AL	3512 HIGHMORE LN	Modesto CA 95357	\$26.00
079-009-049-000	ESQUIVEL DIANA ACEVES DE	3513 BALFOUR LN	Modesto CA 95357	\$26.00
079-009-050-000	PRECIADO CINDY	3517 BALFOUR LN	Modesto CA 95357	\$26.00
079-009-051-000	KUMAR AMAR	3521 BALFOUR LN	Modesto CA 95357	\$26.00
079-009-052-000	PETERSON KAREN TR	3525 BALFOUR LN	Modesto CA 95357	\$26.00
079-009-053-000	PRAKASH SUSHEEL & DEVI VINITA	3529 BALFOUR LN	Modesto CA 95357	\$26.00
079-009-054-000	OSHANA DOONA H	3533 BALFOUR LN	Modesto CA 95357	\$26.00
079-009-055-000	VERSOLA KENNETH O ET AL TRS	3601 BALFOUR LN	Modesto CA 95357	\$26.00
079-009-056-000	MARTINEZ RICHARD A & MARTINEZ MARTHA S	3605 BALFOUR LN	Modesto CA 95354	\$26.00
079-009-057-000	VALADEZ JENISSA	3609 BALFOUR LN	Modesto CA 95357	\$26.00
079-009-058-000	HEDRICK KENNETH L & HEDRICK MARGIE	3613 BALFOUR LN	Modesto CA 95357	\$26.00
079-009-059-000	WASPE LAWRENCE E MD	3617 BALFOUR LN	Modesto CA 95357	\$26.00
079-009-060-000	RODRIGUEZ MARIO & RODRIGUEZ SONIA	3621 BALFOUR LN	Modesto CA 95357	\$26.00
079-009-061-000	CISNEROS STEVE P & CISNEROS ELVIRA	3625 BALFOUR LN	Modesto CA 95357	\$26.00
079-009-062-000	DAVIS RODGER & STACY	3633 ARDIA AVE	Modesto CA 95357	\$26.00
079-010-001-000	HORLICK LUPE CASTILLO ET AL	609 WADDELL WAY	Modesto CA 95357	\$26.00
079-010-002-000	ORTEGA ANGEL GABRIEL	613 WADDELL WAY	Modesto CA 95357	\$26.00
079-010-003-000	TAYLOR DAVID & CHRISTINE	617 WADDELL WAY	Modesto CA 95357	\$26.00
079-010-004-000	LEWIS LA VONA L TR	621 WADDELL WAY	Modesto CA 95357	\$26.00
079-010-005-000	JOHAL TAJINDER & KAUR GURPREET	625 WADDELL WAY	Modesto CA 95357	\$26.00
079-010-006-000	BROWER PROPERTIES 2 LLC	629 WADDELL WAY	Modesto CA 95351	\$26.00
079-010-007-000	BELLIDO RAUL & MERCEDES	633 WADDELL WAY	Modesto CA 95357	\$26.00
079-010-008-000	OLVERA JOSE A	637 WADDELL WAY	Modesto CA 95357	\$26.00
079-010-009-000	PRASAD BINESARI & SATYA W	3700 CREEDMOOR AVE	Modesto CA 95357	\$26.00
079-010-010-000	LERINDEGUI JOYCE C ET AL	3704 CREEDMOOR AVE	Modesto CA 95357	\$26.00
079-010-011-000	TRIO DONNA M	3708 CREEDMOOR AVE	Modesto CA 95357	\$26.00
079-010-012-000	PRASAD RAKESH	3712 CREEDMOOR AVE	Modesto CA 95357	\$26.00
079-010-013-000	ANTONIO MARIA ET AL	3716 CREEDMOOR AVE	Modesto CA 95357	\$26.00
079-010-014-000	STOCKAND MIMI M	3720 CREEDMOOR AVE	Modesto CA 95357	\$26.00
079-010-015-000	ANDRADE ALEX V ET AL	3724 CREEDMOOR AVE	Modesto CA 95357	\$26.00
079-010-016-000	GONZALES JOSEPH R	3728 CREEDMOOR AVE	Modesto CA 95357	\$26.00
079-010-017-000	NELSON RONALD J	3732 CREEDMOOR AVE	Modesto CA 95357	\$26.00
079-010-018-000	GARIBAY GABRIELA & VICTOR ALVAREZ	3736 CREEDMOOR AVE	Modesto CA 95357	\$26.00
079-010-019-000	CHIANG STANLEY & EMILY	3800 CREEDMOOR AVE	Modesto CA 95357	\$26.00
079-010-020-000	AU-YEUNG CHI & AU-YEUNG TZE HING LAM	3804 CREEDMOOR AVE	Modesto CA 95357	\$26.00
079-010-021-000	SALDANA BENJAMIN	3808 CREEDMOOR AVE	Modesto CA 95357	\$26.00
079-010-022-000	VELAZQUEZ RAUL & VELAZQUEZ MARIBEL	3812 CREEDMOOR AVE	Modesto CA 95355	\$26.00
079-010-023-000	XIAOKUN ZHI	3816 CREEDMOOR AVE	Modesto CA 95357	\$26.00
079-010-024-000	STEWART ALLAN HENRY ET AL TRS	3900 CREEDMOOR AVE	Modesto CA 95357	\$26.00

Fee Parcel	Owner	Address	City State Zip	2022-23 Ast.
079-010-025-000	JAMES GLORIA R	3904 CREEDMOOR AVE	Modesto CA 95357	\$26.00
079-010-026-000	RIVERA PAUL C & CARMEN	3908 CREEDMOOR AVE	Modesto CA 95357	\$26.00
079-010-027-000	KUMAR ABINESH	3912 CREEDMOOR AVE	Modesto CA 95357	\$26.00
079-010-028-000	NAMO ALEN	3916 CREEDMOOR AVE	Modesto CA 95357	\$26.00
079-010-029-000	DYRCZ JEFFREY LEE TR	636 CODINGTON WAY	Modesto CA 95357	\$26.00
079-010-030-000	BATTH GURMEET & MANJIT	632 CODINGTON WAY	Modesto CA 95357	\$26.00
079-010-031-000	LYND RICHARD CARROLL	628 CODINGTON WAY	Modesto CA 95357	\$26.00
079-010-032-000	BOWERS MARY P TR	624 CODINGTON WAY	Modesto CA 95357	\$26.00
079-010-033-000	OROZCO VINCENT A & SABRINA E	620 CODINGTON WAY	Modesto CA 95357	\$26.00
079-010-034-000	KING VERONICA	3925 DILLINGHAM AVE	Modesto CA 95357	\$26.00
079-010-035-000	HALE DENNA MICHAEL ET AL TRS	3921 DILLINGHAM AVE	Modesto CA 95357	\$26.00
079-010-036-000	CHARLES TIMOTHY M & CHARLES LISA A	3917 DILLINGHAM AVE	Modesto CA 95357	\$26.00
079-010-037-000	GALLEGOS ELIDIA	3913 DILLINGHAM AVE	Modesto CA 95357	\$26.00
079-010-038-000	RAMIREZ JUAN J & RAQUEL COSIO	3909 DILLINGHAM AVE	Modesto CA 95357	\$26.00
079-010-039-000	MARIGMEN VALERIANO M	3905 DILLINGHAM AVE	Modesto CA 95357	\$26.00
079-010-040-000	VHAN SUNILA TR	3901 DILLINGHAM AVE	Modesto CA 95357	\$26.00
079-010-041-000	PERA ADRIAN C	3825 DILLINGHAM AVE	Modesto CA 95357	\$26.00
079-010-042-000	BRESHEARS DONALD K	3821 DILLINGHAM AVE	Modesto CA 95357	\$26.00
079-010-043-000	DELGADO MIGUEL	3817 DILLINGHAM AVE	Modesto CA 95357	\$26.00
079-010-044-000	JESUS MANUEL A & MARY L TRS	3813 DILLINGHAM AVE	Modesto CA 95357	\$26.00
079-010-045-000	GUZMAN ALEJANDRA ROBLES	3809 DILLINGHAM AVE	Modesto CA 95357	\$26.00
079-010-046-000	MAYA JUAN PABLO BEJARANO	3805 DILLINGHAM AVE	Modesto CA 95357	\$26.00
079-010-047-000	ALBARRAN ARUTRO S & ALBARRAN CELIA P	3801 DILLINGHAM AVE	Modesto CA 95354	\$26.00
079-010-048-000	GALLO MARTIN & GALLO BEATRIZ	3725 DILLINGHAM AVE	Modesto CA 95357	\$26.00
079-010-049-000	SANTOS LUZ MARIA	3721 DILLINGHAM AVE	Modesto CA 95357	\$26.00
079-010-050-000	PEREZ JOSE P & ROSA M	3717 DILLINGHAM AVE	Modesto CA 95357	\$26.00
079-010-051-000	KUMAR ASHOK	3713 DILLINGHAM AVE	Modesto CA 95357	\$26.00
079-010-052-000	MADRIGAL ROBERT	3709 DILLINGHAM AVE	Modesto CA 95357	\$26.00
079-010-053-000	GARDALI CHARLES J TR	3705 DILLINGHAM AVE	Modesto CA 95357	\$26.00
079-010-054-000	JIAO HUIYING TR	3701 DILLINGHAM AVE	Modesto CA 95357	\$26.00
079-011-001-000	MOUNBUA CHANH ET AL	3700 DILLINGHAM AVE	Modesto CA 95354	\$26.00
079-011-002-000	VARGAS EDWARD J & RACHELLE DEE TRS	3704 DILLINGHAM AVE	Modesto CA 95357	\$26.00
079-011-003-000	LIANG JIN & CEN CHUNYAN	3708 DILLINGHAM AVE	Modesto CA 95357	\$26.00
079-011-004-000	KOOCHOU NINOUS & DOMARINA	3712 DILLINGHAM AVE	Modesto CA 95357	\$26.00
079-011-005-000	BAIJAN GEORGE & YOUNAN MARIAM	3716 DILLINGHAM AVE	Modesto CA 95357	\$26.00
079-011-006-000	RODRIGUEZ MARCELINO & RODRIGUEZ ELENA	3720 DILLINGHAM AVE	Modesto CA 95357	\$26.00
079-011-007-000	CHUANGS INVESTMENT INC	3724 DILLINGHAM AVE	Modesto CA 95357	\$26.00
079-011-008-000	ALVES JASON L	3800 DILLINGHAM AVE	Modesto CA 95357	\$26.00
079-011-009-000	WONG SHERRE L TR	3804 DILLINGHAM AVE	Modesto CA 95357	\$26.00
079-011-010-000	COLIN JOSE LUIS FLORES & REMIGIO MARTHA MARISOL MA	3808 DILLINGHAM AVE	Modesto CA 95357	\$26.00
079-011-011-000	KINGSLEY BRANDON K & AMBER N	3812 DILLINGHAM AVE	Modesto CA 95357	\$26.00
079-011-012-000	STILLWELL VINCE & ESCOBAR EVELYN	3816 DILLINGHAM AVE	Modesto CA 95351	\$26.00
079-011-013-000	THOMPSON JAMES ROBERT JR	3820 DILLINGHAM AVE	Modesto CA 95357	\$26.00
079-011-014-000	CABRALES ALEJANDRO	3824 DILLINGHAM AVE	Modesto CA 95357	\$26.00
079-011-015-000	MARTINHO THERESA SILVA TR	3900 DILLINGHAM AVE	Modesto CA 95357	\$26.00
079-011-016-000	CONTRERAS JAVIER	3904 DILLINGHAM AVE	Modesto CA 95357	\$26.00
079-011-017-000	CABRERA MELINDA S	3908 DILLINGHAM AVE	Modesto CA 95357	\$26.00
079-011-018-000	VASQUEZ ROSA	3912 DILLINGHAM AVE	Modesto CA 95357	\$26.00
079-011-019-000	BAXTER RACHEL	3916 DILLINGHAM AVE	Modesto CA 95357	\$26.00
079-011-020-000	MENDEZ JOSE ALVAREZ & TERESA JESUS	3920 DILLINGHAM AVE	Modesto CA 95357	\$26.00
079-011-021-000	SAENGSOORY TONY & SAENGSOORY MARY	3924 DILLINGHAM AVE	Modesto CA 95357	\$26.00
079-011-022-000	MARQUEZ ELIZABETH K & MARQUEZ RICHARD R	616 CODINGTON WAY	Modesto CA 95357	\$26.00
079-011-023-000	TODD BRIAN EDWARD & TRISHA ANN	612 CODINGTON WAY	Modesto CA 95357	\$26.00
079-011-024-000	REGALADO JUAN	608 CODINGTON WAY	Modesto CA 95357	\$26.00
079-011-025-000	CEJA MIGUEL Y & BEATRICE	604 CODINGTON WAY	Modesto CA 95357	\$26.00

Fee Parcel	Owner	Address	City State Zip	2022-23 Ast.
079-011-026-000	MORALES STACIE A	600 CODINGTON WAY	Modesto CA 95357	\$26.00
079-011-027-000	BAUTISTA IRENE TR	3925 ELLENBORO AVE	Modesto CA 95357	\$26.00
079-011-028-000	MUSQUEZ MACARIO F & LISA M	3921 ELLENBORO AVE	Modesto CA 95357	\$26.00
079-011-029-000	DOMINGUEZ NATALIA M ET AL	3917 ELLENBORO AVE	Modesto CA 95357	\$26.00
079-011-030-000	MCKAY JAMES ALLEN & MARY LOU TRS	3913 ELLENBORO AVE	Modesto CA 95357	\$26.00
079-011-031-000	FERNANDEZ ELMA ET AL	3909 ELLENBORO AVE	Modesto CA 95351	\$26.00
079-011-032-000	FANG SUSAN XIUYA	3905 ELLENBORO AVE	Modesto CA 95357	\$26.00
079-011-033-000	MANI GYANESH & SHAKUNTALA	3901 ELLENBORO AVE	Modesto CA 95357	\$26.00
079-011-034-000	LOVE JAMES H & LOVE BRENDA W	3825 ELLENBORO AVE	Modesto CA 95357	\$26.00
079-011-035-000	LEVCHENKO LAURIE	3821 ELLENBORO AVE	Modesto CA 95357	\$26.00
079-011-036-000	KIRKBRIDE CHRISTOPHER CHARLES & LUISA R	3817 ELLENBORO AVE	Modesto CA 95357	\$26.00
079-011-037-000	GALLARDO CLAYTON LEON & VICTORIA SUSANNE	3813 ELLENBORO AVE	Modesto CA 95357	\$26.00
079-011-038-000	PADILLA ROBERTO	3809 ELLENBORO AVE	Modesto CA 95357	\$26.00
079-011-039-000	SPECK HALEY	3805 ELLENBORO AVE	Modesto CA 95357	\$26.00
079-011-040-000	ZAMORA ROBERTO CARLOS LULE & REZA PATRICIA	3801 ELLENBORO AVE	Modesto CA 95357	\$26.00
079-011-041-000	ALDAWOOD PETER SHLIMON & RIMA	3725 ELLENBORO AVE	Modesto CA 95357	\$26.00
079-011-042-000	MORRIS SAMUEL DAVID ET AL	3721 ELLENBORO AVE	Modesto CA 95357	\$26.00
079-011-043-000	LOPEZ DIANA MORENO	3717 ELLENBORO AVE	Modesto CA 95357	\$26.00
079-011-044-000	KEYGHALDI KARNAVAL & ESTER	3713 ELLENBORO AVE	Modesto CA 95351	\$26.00
079-011-045-000	COSTA WILMA D & DAVID JR	3709 ELLENBORO AVE	Modesto CA 95357	\$26.00
079-011-046-000	BURCIU VASILE & TABITA	3705 ELLENBORO AVE	Modesto CA 95357	\$26.00
079-011-047-000	CHIHIL JOSEPHINE U TR	3701 ELLENBORO AVE	Modesto CA 95357	\$26.00
079-012-001-000	HONBERGER ROBERT & HONBERGER LISA	541 WADDELL WAY	Modesto CA 95357	\$26.00
079-012-002-000	BETYAGHOUB VILHAM & LINDA	545 WADDELL WAY	Modesto CA 95357	\$26.00
079-012-003-000	WONG SAI YING & LIXIAN KUANG TRS	549 WADDELL WAY	Modesto CA 95357	\$26.00
079-012-004-000	KUWAMOTO LARRY & BETTY TRS	553 WADDELL WAY	Modesto CA 95357	\$26.00
079-012-005-000	CHAND ATISH & REENA	557 WADDELL WAY	Modesto CA 95357	\$26.00
079-012-006-000	PEERA ALBERTA	601 WADDELL WAY	Modesto CA 95357	\$26.00
079-012-007-000	SUAREZ-MILLAN THANIA A	3700 ELLENBORO AVE	Modesto CA 95357	\$26.00
079-012-008-000	MARENTES YESENIA	3704 ELLENBORO AVE	Modesto CA 95357	\$26.00
079-012-009-000	MOORE MICHAEL	3708 ELLENBORO AVE	Modesto CA 95357	\$26.00
079-012-010-000	KIDD BRIAN & KIDD KIMBERLY	3712 ELLENBORO AVE	Modesto CA 95357	\$26.00
079-012-011-000	ESTRADA JOSE & ALICIA	3716 ELLENBORO AVE	Modesto CA 95357	\$26.00
079-012-012-000	SERRANO GUADALUPE & MARIA ELENA	3720 ELLENBORO AVE	Modesto CA 95357	\$26.00
079-012-013-000	MIRANDA CYNTHIA & MAGANA JOSE LUIS BARRAGAN	3724 ELLENBORO AVE	Modesto CA 95357	\$26.00
079-012-014-000	GILL HARMAIL & DARSHAN	3800 ELLENBORO AVE	Modesto CA 95357	\$26.00
079-012-015-000	BARRIENTOS JAVIER & ARCADIA	3804 ELLENBORO AVE	Modesto CA 95357	\$26.00
079-012-016-000	CORRAL SANDRA	3808 ELLENBORO AVE	Modesto CA 95357	\$26.00
079-012-017-000	CHUANG TINA Y	3812 ELLENBORO AVE	Modesto CA 95357	\$26.00
079-012-018-000	AGAS JANELYN R	3816 ELLENBORO AVE	Modesto CA 95357	\$26.00
079-012-019-000	MADEROS KATHLEEN J	3820 ELLENBORO AVE	Modesto CA 95357	\$26.00
079-012-020-000	BRITZKE GARY T & BRITZKE PATRICIA L	3824 ELLENBORO AVE	Modesto CA 95357	\$26.00
079-012-021-000	PENA BERNIE & PENA TREANNA	3900 ELLENBORO AVE	Modesto CA 95357	\$26.00
079-012-022-000	BP 4 LLC	3904 ELLENBORO AVE	Modesto CA 95357	\$26.00
079-012-023-000	SOLOMON JEAN M TR	3908 ELLENBORO AVE	Modesto CA 95357	\$26.00
079-012-024-000	THOMAS DOUGLAS E & GLENDA J	3912 ELLENBORO AVE	Modesto CA 95357	\$26.00
079-012-025-000	NAVARRETTE DANIEL & MONIQUE MARY	3916 ELLENBORO AVE	Modesto CA 95357	\$26.00
079-012-026-000	BARCELO PATRICIA	3920 ELLENBORO AVE	Modesto CA 95357	\$26.00
079-012-027-000	MATA JUAN W ETA L	3924 ELLENBORO AVE	Modesto CA 95357	\$26.00
079-012-028-000	SALINAS ELIZABETH & ALBERT	556 CODINGTON WAY	Modesto CA 95357	\$26.00
079-012-029-000	AUSTIN BEVERLY	552 CODINGTON WAY	Modesto CA 95357	\$26.00
079-012-030-000	VALLADOLID RAMIRO & DE VALLADOLID MA CRUZ COBARRUB	548 CODINGTON WAY	Modesto CA 95350	\$26.00
079-012-031-000	CHAIRES MICHAEL	544 CODINGTON WAY	Modesto CA 95357	\$26.00
079-012-032-000	TAH 2016-1 BORROWER LLC	540 CODINGTON WAY	Modesto CA 95357	\$26.00

Fee Parcel	Owner	Address	City State Zip	2022-23 Ast.
079-012-033-000	MC CLELLAN BRYCE	3925 GATESVILLE AVE	Modesto CA 95357	\$26.00
079-012-034-000	WILDEMAN GALEN J	3921 GATESVILLE AVE	Modesto CA 95354	\$26.00
079-012-035-000	RATANA KAM & RATANA TIMOTHY	3917 GATESVILLE AVE	Modesto CA 95357	\$26.00
079-012-036-000	SORIA RUBEN & SORIA GLORIA L	3913 GATESVILLE AVE	Modesto CA 95357	\$26.00
079-012-037-000	ORNELAS GABRIEL M & KATLYN T	3909 GATESVILLE AVE	Modesto CA 95357	\$26.00
079-012-038-000	TORRES VICTOR MANUEL & PANTOJA MARIA	3905 GATESVILLE AVE	Modesto CA 95357	\$26.00
079-012-039-000	OLMOS GUADALUPE	3901 GATESVILLE AVE	Modesto CA 95357	\$26.00
079-012-040-000	GRAVES LINDA M	3825 GATESVILLE AVE	Modesto CA 95357	\$26.00
079-012-041-000	TUERS TERRY B & TUERS LENORE L	3821 GATESVILLE AVE	Modesto CA 95357	\$26.00
079-012-042-000	KINNE DONNELLY & SUSAN N TRS	3817 GATESVILLE AVE	Modesto CA 95357	\$26.00
079-012-043-000	ORNELAS RUI & ELISANGELA	3813 GATESVILLE AVE	Modesto CA 95357	\$26.00
079-012-044-000	BUSH CHARLES F & BUSH DONNA L	3809 GATESVILLE AVE	Modesto CA 95357	\$26.00
079-012-045-000	PENA JOSEPH	3805 GATESVILLE AVE	Modesto CA 95354	\$26.00
079-012-046-000	ODISHO CATHERINE ET AL	3801 GATESVILLE AVE	Modesto CA 95357	\$26.00
079-012-047-000	SHEPHERD NORMAN E & LISA N	3725 GATESVILLE AVE	Modesto CA 95357	\$26.00
079-012-048-000	BARTHOLOMEW RUSSELL RAY	3721 GATESVILLE AVE	Modesto CA 95357	\$26.00
079-012-049-000	RUSSELL GARRICK	3717 GATESVILLE AVE	Modesto CA 95357	\$26.00
079-012-050-000	JENSEN STEVEN H & TONJA R	3713 GATESVILLE AVE	Modesto CA 95357	\$26.00
079-012-051-000	PATEL JAGUBHAI & PATEL GANGABEN	3709 GATESVILLE AVE	Modesto CA 95357	\$26.00
079-012-052-000	NELSON LESTER J & NELSON CRESENCIA	3705 GATESVILLE AVE	Modesto CA 95326	\$26.00
079-012-053-000	MUTOZA CRAIG J	3701 GATESVILLE AVE	Modesto CA 95357	\$26.00
079-013-001-000	HERNANDEZ ELI U ET AL	521 WADDELL WAY	Modesto CA 95357	\$26.00
079-013-002-000	VARGAS EDWARD J & RACHELLE DEE TRS	525 WADDELL WAY	Modesto CA 95357	\$26.00
079-013-003-000	ROCHA JAMES JOHN TRS ET AL	529 WADDELL WAY	Modesto CA 95354	\$26.00
079-013-004-000	VANDERHEIDEN ROBIN	533 WADDELL WAY	Modesto CA 95357	\$26.00
079-013-005-000	CORREA ARMANDO M JR & IRMA A	537 WADDELL WAY	Modesto CA 95356	\$26.00
079-013-006-000	RIVERA GRISELDA	3700 GATESVILLE AVE	Modesto CA 95357	\$26.00
079-013-007-000	BATEMAN WALTER	3704 GATESVILLE AVE	Modesto CA 95357	\$26.00
079-013-008-000	GOUVEIA JOHN E & TERRE L TRS	3708 GATESVILLE AVE	Modesto CA 95357	\$26.00
079-013-009-000	REYES RENE ET AL	3712 GATESVILLE AVE	Modesto CA 95357	\$26.00
079-013-010-000	LE CANH & TIEU MY HA	3716 GATESVILLE AVE	Modesto CA 95357	\$26.00
079-013-011-000	AYALA DIEGO ADRIAN ET AL	3720 GATESVILLE AVE	Modesto CA 95357	\$26.00
079-013-012-000	MARTINEZ MA DEL REFUGIO MORA	3724 GATESVILLE AVE	Modesto CA 95357	\$26.00
079-013-013-000	MARTINEZ PEDRO & IRMA	3800 GATESVILLE AVE	Modesto CA 95357	\$26.00
079-013-014-000	LONN JASON ASHLEY & ROCHELLE JOAN	3804 GATESVILLE AVE	Modesto CA 95357	\$26.00
079-013-015-000	GOLIB VILMA	3808 GATESVILLE AVE	Modesto CA 95357	\$26.00
079-013-016-000	PARKINSON MARK & DIANE	3812 GATESVILLE AVE	Modesto CA 95357	\$26.00
079-013-017-000	BROWN WILLIAM K & SHAMIRAN A	3816 GATESVILLE AVE	Modesto CA 95357	\$26.00
079-013-018-000	OXFORD DAVID C JR	3820 GATESVILLE AVE	Modesto CA 95357	\$26.00
079-013-019-000	TAPIA YER YANG ET AL	3824 GATESVILLE AVE	Modesto CA 95357	\$26.00
079-013-020-000	PHILLIPS AUDREY M	3900 GATESVILLE AVE	Modesto CA 95357	\$26.00
079-013-021-000	ELLIOTT CRAIG	3904 GATESVILLE AVE	Modesto CA 95357	\$26.00
079-013-022-000	WADE THAREN SCOTT II	3908 GATESVILLE AVE	Modesto CA 95357	\$26.00
079-013-023-000	GUARDADO ARIEL	3912 GATESVILLE AVE	Modesto CA 95357	\$26.00
079-013-024-000	JOLLIFF GARTH E & COEY-JOLLIFF KATHERINE A TRS	3916 GATESVILLE AVE	Modesto CA 95357	\$26.00
079-013-025-000	BAXTER RACHEL A	3920 GATESVILLE AVE	Modesto CA 95357	\$26.00
079-013-026-000	YIP AARON K & ELISE H	3924 GATESVILLE AVE	Modesto CA 95357	\$26.00
079-013-027-000	FARIAS ROBERTO F & ELIZABETH	536 CODINGTON WAY	Modesto CA 95357	\$26.00
079-013-028-000	MORENO EDUARDO MARTINEZ	532 CODINGTON WAY	Modesto CA 95350	\$26.00
079-013-029-000	ZAVALA CLEMENTE JR & ZAVALA IRMA	528 CODINGTON WAY	Modesto CA 95357	\$26.00
079-013-030-000	OCHOA SANJUANA	524 CODINGTON WAY	Modesto CA 95357	\$26.00
079-013-031-000	MIRANDA SERGIO & SANDRA C	520 CODINGTON WAY	Modesto CA 95357	\$26.00
079-013-032-000	DELACRUZ JENNIFER ROBYN	3925 LAURENBURG AVE	Modesto CA 95357	\$26.00
079-013-033-000	LE NHI UYEN	3921 LAURENBURG AVE	Modesto CA 95357	\$26.00
079-013-034-000	RODRIGUEZ MANUEL & MARIA E TRS	3917 LAURENBURG AVE	Modesto CA 95357	\$26.00

Fee Parcel	Owner	Address	City State Zip	2022-23 Ast.
079-013-035-000	GUZMAN JONATHAN	3913 LAURENBURG AVE	Modesto CA 95357	\$26.00
079-013-036-000	HENDERSON DAVID DUANE TR	3909 LAURENBURG AVE	Modesto CA 95357	\$26.00
079-013-037-000	SHAMESALDIN JOHNY K & SHAMESALDIN MUNA M	3905 LAURENBURG AVE	Modesto CA 95357	\$26.00
079-013-038-000	JOSEPHSON JOSEPH CLAYTON	3901 LAURENBURG AVE	Modesto CA 95357	\$26.00
079-013-039-000	MELENDEZ MARIA & WALKER DANIEL	3825 LAURENBURG AVE	Modesto CA 95357	\$26.00
079-013-040-000	TREVINO TONY & GERALDINE	3821 LAURENBURG AVE	Modesto CA 95357	\$26.00
079-013-041-000	HERNANDEZ SALVADOR M & HERNANDEZ NILDA M	3817 LAURENBURG AVE	Modesto CA 95357	\$26.00
079-013-042-000	PINAL RAMIRO ET AL	3813 LAURENBURG AVE	Modesto CA 95357	\$26.00
079-013-043-000	AQUINO J GABRIEL MENDOZA & MENDOZA NIEVES	3809 LAURENBURG AVE	Modesto CA 95357	\$26.00
079-013-044-000	ATHNEIL GEORGE K & ATHNEIL INAAM M	3805 LAURENBURG AVE	Modesto CA 95357	\$26.00
079-013-045-000	ALVARADO ALFONSO F	3801 LAURENBURG AVE	Modesto CA 95357	\$26.00
079-013-046-000	DUNN JAY ALAN TR	3725 LAURENBURG AVE	Modesto CA 95357	\$26.00
079-013-047-000	WATKINS WALLY T & LAUREN A	3721 LAURENBURG AVE	Modesto CA 95357	\$26.00
079-013-048-000	CHAND VIJAY ET AL	3717 LAURENBURG AVE	Modesto CA 95357	\$26.00
079-013-049-000	SABINIANO MARLON N ET AL	3713 LAURENBURG AVE	Modesto CA 95357	\$26.00
079-013-050-000	FREY SHERYL LYNN	3709 LAURENBURG AVE	Modesto CA 95357	\$26.00
079-013-051-000	GARDUNO IRINEO ET AL	3705 LAURENBURG AVE	Modesto CA 95357	\$26.00
079-013-052-000	LOPEZ MARIO & LUZ ELVIRA	3701 LAURENBURG AVE	Modesto CA 95357	\$26.00
079-014-001-000	GARCIA MIGUEL & GARCIA MARIA	449 WADDELL WAY	Modesto CA 95357	\$26.00
079-014-002-000	CABAGNOT DOLORES R & FLYNN G	501 WADDELL WAY	Modesto CA 95357	\$26.00
079-014-003-000	CRUZ ZANDHER LYN ET AL	505 WADDELL WAY	Modesto CA 95357	\$26.00
079-014-004-000	WILSON KELLIE MICHELLE & RYAN CHRISTOPHER	509 WADDELL WAY	Modesto CA 95357	\$26.00
079-014-005-000	NOUN SAMNANG	513 WADDELL WAY	Modesto CA 95357	\$26.00
079-014-006-000	SANCHEZ JOSE L & MADRIGAL ALICIA	517 WADDELL WAY	Modesto CA 95357	\$26.00
079-014-007-000	AUSTIN CATHERINE ANN TR	3700 LAURENBURG AVE	Modesto CA 95357	\$26.00
079-014-008-000	BECERRA-BARRERA GERMAN & BECERRA LUISA G	3704 LAURENBURG AVE	Modesto CA 95357	\$26.00
079-014-009-000	MILTON JEANNIE	3708 LAURENBURG AVE	Modesto CA 95357	\$26.00
079-014-010-000	CASTRO GREGORY ALAN & BARBARA LYNN TRS	3712 LAURENBURG AVE	Modesto CA 95357	\$26.00
079-014-011-000	DIXON GARY W TR	3716 LAURENBURG AVE	Modesto CA 95357	\$26.00
079-014-012-000	AMES ADELE TR	3720 LAURENBURG AVE	Modesto CA 95357	\$26.00
079-014-013-000	WARNER JO ANNE	3724 LAURENBURG AVE	Modesto CA 95357	\$26.00
079-014-014-000	GARCIA THERESA L	3800 LAURENBURG AVE	Modesto CA 95357	\$26.00
079-014-015-000	BERGHORST REBECCA L ET AL	3804 LAURENBURG AVE	Modesto CA 95354	\$26.00
079-014-016-000	GLOVER KEITH R & MENDOZA ARACELI CORRAL	3808 LAURENBURG AVE	Modesto CA 95357	\$26.00
079-014-017-000	DHIR ASHIKA ET AL	3812 LAURENBURG AVE	Modesto CA 95357	\$26.00
079-014-018-000	RIVERA DAYSI M	3816 LAURENBURG AVE	Modesto CA 95357	\$26.00
079-014-019-000	HUYNH NGOCDUNG THI ET AL	3820 LAURENBURG AVE	Modesto CA 95357	\$26.00
079-014-020-000	CASTANEDA JOSE J & MARGARET	3824 LAURENBURG AVE	Modesto CA 95357	\$26.00
079-014-021-000	GUZMAN MIRIAM & FLORES MARTIN	3900 LAURENBURG AVE	Modesto CA 95357	\$26.00
079-014-022-000	SEUGA HOWLAND P	3904 LAURENBURG AVE	Modesto CA 95357	\$26.00
079-014-023-000	TORRES JOSE DE JESUS & TORRES MARIA DOLORES	3908 LAURENBURG AVE	Modesto CA 95357	\$26.00
079-014-024-000	HO KAI-YIN SILAS & WANG LI	3912 LAURENBURG AVE	Modesto CA 95357	\$26.00
079-014-025-000	OAKLEY CHRISTOPHER PERRY & JACQUELINE	3916 LAURENBURG AVE	Modesto CA 95357	\$26.00
079-014-026-000	TRAN TRUYEN THANH & NGUYEN HUNG P	3920 LAURENBURG AVE	Modesto CA 95357	\$26.00
079-014-027-000	THOMPSON JAMIE ROBERTA	3924 LAURENBURG AVE	Modesto CA 95357	\$26.00
079-014-028-000	PIERCE FRANKLIN C & JODI L	516 CODINGTON WAY	Modesto CA 95357	\$26.00
079-014-029-000	PRASAD SURESH & PRASAD MUNI L	512 CODINGTON WAY	Modesto CA 95357	\$26.00
079-014-030-000	CASTELLANOS RIGOBERTO	508 CODINGTON WAY	Modesto CA 95357	\$26.00
079-014-031-000	NUON SOPHEAP & OUM SAVANARA	504 CODINGTON WAY	Modesto CA 95357	\$26.00
079-014-032-000	ROCHA ROBERTO T	500 CODINGTON WAY	Modesto CA 95357	\$26.00
079-014-033-000	ATWOOD BOBBY D	3925 WILKESBORO AVE	Modesto CA 95357	\$26.00
079-014-034-000	BEST JERROLIN E	3921 WILKESBORO AVE	Modesto CA 95357	\$26.00
079-014-035-000	GIOVANNONI CASEY L	3917 WILKESBORO AVE	Modesto CA 95357	\$26.00
079-014-036-000	MALIK ROBERT	3913 WILKESBORO AVE	Modesto CA 95357	\$26.00
079-014-037-000	VACA ANDRES SERVIN	3909 WILKESBORO AVE	Modesto CA 95357	\$26.00

Fee Parcel	Owner	Address	City State Zip	2022-23 Ast.
079-014-038-000	CHAU VINCENT	3905 WILKESBORO AVE	Modesto CA 95357	\$26.00
079-014-039-000	ROSAS CLAUDIA L & SAMUEL	3901 WILKESBORO AVE	Modesto CA 95357	\$26.00
079-014-040-000	YOUNG HOLLY M ET AL	3825 WILKESBORO AVE	Modesto CA 95357	\$26.00
079-014-041-000	FAMA JOSELITO & FAMA DOROTEA	3821 WILKESBORO AVE	Modesto CA 95357	\$26.00
079-014-042-000	CICERO THEODORE JR & CAROL	3817 WILKESBORO AVE	Modesto CA 95357	\$26.00
079-014-043-000	CABRERA THOMAS & CABRERA JANET S L	3813 WILKESBORO AVE	Modesto CA 95357	\$26.00
079-014-044-000	RIVERA LOUIS S & LOUELLA J TRS	3809 WILKESBORO AVE	Modesto CA 95357	\$26.00
079-014-045-000	JARAMILLO ARTURO	3805 WILKESBORO AVE	Modesto CA 95357	\$26.00
079-014-046-000	ROGERS MEGAN ET AL	3801 WILKESBORO AVE	Modesto CA 95357	\$26.00
079-014-047-000	BATTAN KRISHAN RAAJ	3725 WILKESBORO AVE	Modesto CA 95357	\$26.00
079-014-048-000	BAINS SARVSATINDER & BELBINDER K	3721 WILKESBORO AVE	Modesto CA 95357	\$26.00
079-014-049-000	BOUCHER GARY C & BOUCHER DENISE K	3717 WILKESBORO AVE	Modesto CA 95357	\$26.00
079-014-050-000	POWLEY ANAMARIA	3713 WILKESBORO AVE	Modesto CA 95357	\$26.00
079-014-051-000	PRASAD GEORGE & PRASAD LALITA	3709 WILKESBORO AVE	Modesto CA 95357	\$26.00
079-014-052-000	WARD JODY LEE & CHEN QIAO	3705 WILKESBORO AVE	Modesto CA 95357	\$26.00
079-014-053-000	BENJAMIN LINDA & EUGENE	3701 WILKESBORO AVE	Modesto CA 95357	\$26.00
079-016-001-000	COLLINS TOMMY S	440 WADDELL WAY	Modesto CA 95357	\$26.00
079-016-002-000	BIRD BYRON M	3704 WILKESBORO AVE	Modesto CA 95357	\$26.00
079-016-003-000	BARNES REECE WAYNE	3708 WILKESBORO AVE	Modesto CA 95357	\$26.00
079-016-004-000	BIERMAN ALLEN	3712 WILKESBORO AVE	Modesto CA 95357	\$26.00
079-016-005-000	PRASAD VIJAY	3716 WILKESBORO AVE	Modesto CA 95357	\$26.00
079-016-006-000	GONZALEZ JOSE	3720 WILKESBORO AVE	Modesto CA 95357	\$26.00
079-016-007-000	GONZALEZ JAIME J & SAUCEDA PERLA R	3800 WILKESBORO AVE	Modesto CA 95357	\$26.00
079-016-008-000	KOHN RONALD & JUANITA I	3804 WILKESBORO AVE	Modesto CA 95357	\$26.00
079-016-009-000	CANCINO DANIEL DISU & FEDERICA BERNARTE TRS	3808 WILKESBORO AVE	Modesto CA 95354	\$26.00
079-016-010-000	ROSALES JOSE L & FRANCO MARIA T	3812 WILKESBORO AVE	Modesto CA 95357	\$26.00
079-016-011-000	STINHILVER WILLARD & STINHILVER MARLENE	3816 WILKESBORO AVE	Modesto CA 95357	\$26.00
079-016-012-000	CAMERON CHERYLE A	3820 WILKESBORO AVE	Modesto CA 95357	\$26.00
079-016-013-000	TORRES LUIS BENITEZ	3824 WILKESBORO AVE	Modesto CA 95357	\$26.00
079-016-014-000	LUZUNARIS MIGUEL ORLANDO	3900 WILKESBORO AVE	Modesto CA 95357	\$26.00
079-016-015-000	OU KANG YE & LIANG LIZHEN	3904 WILKESBORO AVE	Modesto CA 95354	\$26.00
079-016-016-000	VILLASENOR RICARDO & ANA L RAMINEZ DE	3908 WILKESBORO AVE	Modesto CA 95357	\$26.00
079-016-017-000	MANSOUR ALEN M	3912 WILKESBORO AVE	Modesto CA 95357	\$26.00
079-016-018-000	EASTHAM GLENDA S	3916 WILKESBORO AVE	Modesto CA 95357	\$26.00
079-016-019-000	GUZMAN HORACIO GARNICA & ALICIA BARBOSA	3920 WILKESBORO AVE	Modesto CA 95357	\$26.00
079-016-020-000	SOLORIO SAMMY	3924 WILKESBORO AVE	Modesto CA 95357	\$26.00
079-016-021-000	SINGH AJESH & AACHAL	440 CODINGTON WAY	Modesto CA 95357	\$26.00
079-016-022-000	JOHNSON ALOMA J & VELTON JR	436 CODINGTON WAY	Modesto CA 95357	\$26.00

THIS PAGE HAS BEEN INTENTIONALLY LEFT BLANK